

Mode	d'emploi	-	Gamme	Compact	59
User	Manual	-	Compact	59	Range
Gebrauchsanweisung		-	Reihe	Compact	59
Modo	de	empleo	-	Gama	Compact 59
Gebruiksaanwijzing		-	Compact	59-lijn	



EUROCAVE<sup>®</sup> 

Des solutions adaptées à tous vos besoins - Solutions to meet all your needs  
 All Ihren Bedürfnissen angepaßte Lösungen - Soluciones adaptadas a todas sus necesidades  
 Oplossingen aangepast aan uw behoeften - Soluzioni adatte a tutte le vostre esigenze

**EUROCAVE - CAVES À VIN - WINE CABINETS - WEINKLIMASCHRÄNKE - ARMARIOS PARA VINOS - WIJNKASTEN - CANTINETTE PER VINI**



**Compact**



**Pure**



**Revelation**



**Collection**



**Tête à Tête**



**Cuir - Leather**



**Elite - Cave à Cigares / Cigar Humidor**



**Wine Art**

**EUROCAVE - SYSTÈMES DE RANGEMENT - STORAGE SYSTEMS - REGALSYSTEME  
 SISTEMAS DE COLOCACIÓN - OPBERGSYSTEMEN - SISTEMI DI STOCCAGGIO**



**Modulosteel**



**Modulothèque**



**Modulorack - Inoa®**

**GAMME EUROCAVE PROFESSIONAL - EUROCAVE PROFESSIONAL RANGE  
 REIHE EUROCAVE PROFESSIONAL - GAMA EUROCAVE PROFESSIONAL  
 EUROCAVE PROFESSIONAL-LIJN - GAMMA EUROCAVE PROFESSIONAL**



**Gamme 5000**



**ShowCave**



**Vin au Verre®**



**Wine Bar®**

## WELCOME

You have just purchased a EuroCave product – thank you for your custom. We take particular care in manufacturing our products in terms of their design, ergonomics and ease of use. We hope that you will be completely satisfied with this product.

## PLEASE NOTE

The information contained in this document may be changed without warning.

EuroCave offers no guarantee for this appliance when it is used for purposes other than those for which it was designed. EuroCave shall not be held responsible for any errors contained in this manual or for any damage linked to or resulting from the supply, performance or use of this appliance.

This document contains original information, which is protected by copyright. All rights are reserved. Photocopying, reproducing or translating this document, whether partially or completely, is strictly forbidden, without EuroCave's prior written consent.

This appliance is intended solely for storing wine.

It is not designed to be used by people (including children) with reduced mental, sensorial or physical abilities, or by people who have no experience or knowledge, unless they have first received instructions on how to use the machine or are supervised by a person responsible for their safety.

Children must be supervised to ensure that they do not play with the appliance.

If the power lead is damaged, it must be replaced by a special cable or unit available from the manufacturer or its customer service department.

### WARNING:

- Ensure that the air vents in the appliance's cavity and the flush-fitting structure are unobstructed.
- Do not use mechanical devices or other means to speed up the defrosting process other than those recommended by the manufacturer.
- Do not damage the refrigeration circuit.
- Do not use electrical appliances inside the wine storage compartment, unless they have been recommended by the manufacturer.
- Do not store explosive substances in this appliance such as aerosols containing flammable propellant gas.

This appliance is intended for domestic and similar applications such as:

- kitchenettes reserved for staff of shops, offices and other professional environments;
- gites and use by guests of hotels, motels and other environments which are residential in nature
- hotel rooms;
- the food service industry and other similar applications except for retail sale.

# WELCOME TO THE WORLD OF EUROCAVE

Our biding desire is to support your passion for wine throughout the years... To do so, EuroCave has used all of its expertise to bring together the six essential criteria for serving wine:

## Temperature

The two enemies of wine are extreme temperatures and sudden changes in temperature. A constant temperature allows the wine to fully develop.

## Humidity

It's an essential factor, allowing the corks to retain their sealing properties. The level of humidity must be greater than 50 % (ideally between 60 and 75 %).

## Protection from Light

Light, particularly its U.V. component, causes wine to quickly deteriorate by irreversible oxidation of tannins. It is therefore strongly recommended that you store wine in a dark place or protected from U.V. light.

## Vibration

Vibrations disturb wine's slow biochemical development process and are often fatal for your finest wines. The "Main du Sommelier" supports adapt to the shape of the bottle and protect it from vibrations (anti-vibration technology).

## Air circulation

A constant supply of fresh air prevents mould from developing in your cabinet. EuroCave cabinets benefit from a ventilation system with breather effect, which makes it very similar to the ventilation system of a natural cellar.

## Storage

Moving bottles too often is harmful to wine. Having suitable storage that limits handling is essential.

All of these specific features are found in the Compact 59 wine cabinet by EuroCave that you have just purchased. Thank you for placing your trust in us.

## Standard wine serving temperatures

### French wines

Alsace	10 °C/50 °F
Beaujolais	13 °C/55 °F
Sweet white Bordeaux	6 °C/43 °F
Dry white Bordeaux	8 °C/46 °F
Bordeaux reds	17 °C/63 °F
Burgundy whites	11 °C/52 °F
Burgundy reds	18 °C/64 °F
Champagne	6 °C/43 °F
Jura	10 °C/50 °F
Languedoc-Roussillon	13 °C/55 °F
Provence Rosé	12 °C/54 °F
Savoie	9 °C/48 °F
Dry white Loire wines	13 °C/55 °F
Sweet white Loire wines	7 °C/45 °F
Loire reds	14 °C/57 °F
Rhône wines	15 °C/59 °F
Sweet wines from the South-West	7 °C/45 °F
Reds from the South-West	15 °C/59 °F

### Australian wines

Cabernet franc	16 °C/61 °F
Cabernet sauvignon	17 °C/63 °F
Chardonnay	10 °C/50 °F
Merlot	17 °C/63 °F
Muscat à petit grain	6 °C/43 °F
Pinot noir	15 °C/59 °F
Sauvignon blanc	8 °C/46 °F
Semillon	8 °C/46 °F
Shiraz	18 °C/64 °F
Verdhelo	7 °C/45 °F

### Other wines

Californie	16 °C/61 °F
Chilean	15 °C/59 °F
Spanish	17 °C/63 °F
Italian	16 °C/61 °F





<b>1 - Description of your wine cabinet</b>	<b>24</b>
---	-----------



<b>2 - Power supply</b>	<b>25</b>
-------------------------	-----------



<b>3 - Protecting the environment and energy-saving</b>	<b>25</b>
---	-----------



<b>4 - Installing your wine cabinet</b>	<b>26</b>
---	-----------

I - Building in	27
II - Reversibility of the lock	30
III - Alternative hanging of a door (solid or glass)	31



<b>5 - Arrangement - Storage</b>	<b>32</b>
----------------------------------	-----------



<b>6 - Commissioning your wine cabinet</b>	<b>34</b>
--	-----------

I - Connection	34
II-A - Description (I-temperature model V059 - V259)	34
III-A - Temperature settings	34
II-B - Description (multi-temperatures model S059 - S259)	35
III-B - Temperature settings	35
IV - Humidity level display	36
V - Lighting mode adjustment	36
VI - Carbon filter counter log display	36



<b>7 - Everyday maintenance</b>	<b>37</b>
---------------------------------	-----------



<b>8 - Operating faults</b>	<b>37</b>
-----------------------------	-----------

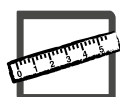

<b>9 - Energy and technical features</b>	<b>38</b>
--	-----------



<b>10 - Storage layout examples</b>	<b>93</b>
-------------------------------------	-----------



# I - DESCRIPTION OF YOUR WINE CABINET

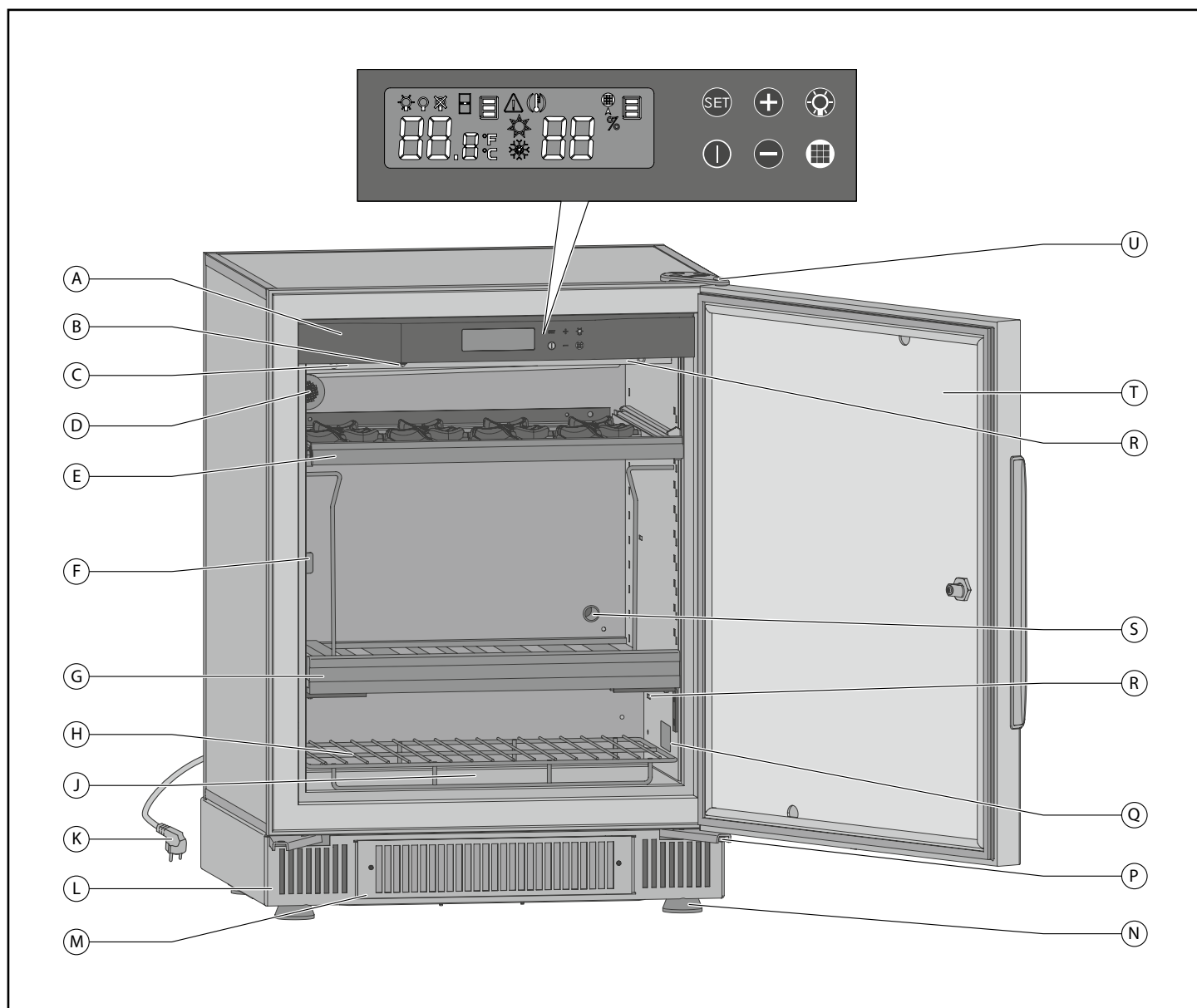

- A** Control and adjustment panel
- B** Light (2 leds)
- C** Location of temperature probe in I temperature models
- D** Air circulation hole + Active carbon filter
- E** Sliding shelf
- F** Closing clip
- G** Storage shelf
- H** Grid
- J** Humidity cassette (I temperature models)
- K** Power lead

- L** Base with front ventilation
- M** Filter access grille + aeration filter
- N** 4 adjustable levelling feet
- P** Lower hinge (x2)
- Q** Specification label
- R** Location of temperature probe in multiple temperature models
- S** Free air circulation hole
- T** Door (fitted with handle and a double movement lock)
- U** Upper hinge

## 2 - POWER SUPPLY



i

**For your personal safety, the wine cabinet must be correctly earthed. Ensure that the plug is correctly earthed and that your installation is protected by a circuit breaker (30 mA\*).**  
\*not applicable to some countries.

The wine cabinet power lead has a plug to be plugged into a standard earthed socket to prevent any risk of electric shock.



Have the mains socket inspected by a qualified electrician who will check that it is correctly earthed and will carry out, if need be, work to bring your installation into line with standards.

Contact your usual EuroCave dealer to change the power lead if it is damaged. It must be replaced by a part which has an original manufacturer's guarantee.



If you are moving to a foreign country, check whether or not the cabinet's characteristics correspond to the country (voltage, frequency).

## 3 - ENVIRONMENTAL PROTECTION AND POWER SAVING



### Disposing of packaging

The packaging used by EuroCave is produced in recyclable materials.

After unpacking your cabinet, take the packaging to a refuse collection point. For the most part, it will be recycled.

### Recycling: a caring gesture

Electronic and electrical equipment has potentially harmful effects on the environment and human health, owing to the presence of dangerous substances.

Therefore, you must not trash electrical and electronic equipment with non-sorted municipal waste.

When purchasing a new EuroCave product, you can entrust the recycling of your old appliance to your EuroCave dealer.

Speak to your EuroCave dealer, he will advise you on the disposal and collection arrangements set up within the EuroCave network.

In compliance with legislation on protecting and caring for the environment, your wine cabinet does not contain C.F.C.s.

### Energy-saving

Install your cabinet in a suitable location (see following page) and observe the recommended temperature ranges.

- Keep the door open only for very short periods.
- Ensure that the door seal is intact and that it is not damaged. If it is, contact your EuroCave dealer.

Disable unusable appliances by unplugging them and removing the power lead.



## 4 - INSTALLING YOUR WINE CABINET

### Unpacking

- Check, when your cabinet is delivered, that it does not have any external faults (impact, warping...).
- Open the door and check the integrity of the inside of your appliance (walls, Main du Sommelier supports, hinges, bottle support...).
- Remove the protective packing inside the humidor.

If there is a problem, contact your EuroCave dealer.

### Installation



**When moving the cabinet, do not tilt it more than 45° and always on the lateral side, on the side of the flexible cord.**

### Précautions

- Do not place your cabinet in an area likely to be flooded.
- Do not position your cabinet near to a source of heat or expose it to the effects of direct sunlight.
- Prevent water from splashing on the entire rear section of the appliance.
- Position your appliance so that there is a minimum space of 5 – 10 cm between the wall and the rear wall of your cabinet.
- If you are positioning your cabinet under a work surface, leave a minimum space of 5 cm all around the appliance including under the work surface. Allow for a ventilation grill on the work surface (recommended).
- Arrange the power lead so that it is accessible and does not come into contact with any component of the appliance..
- Slightly tilt the cabinet backwards to adjust the front feet (adjusted by screwing or unscrewing), so that you can level your cabinet (use of a spirit level is recommended).
- Install the carbon filter, which you will find inside your cabinet's "accessories" packet, by placing it in the air circulation hole located inside the cabinet on the top left hand side (see diagram below).

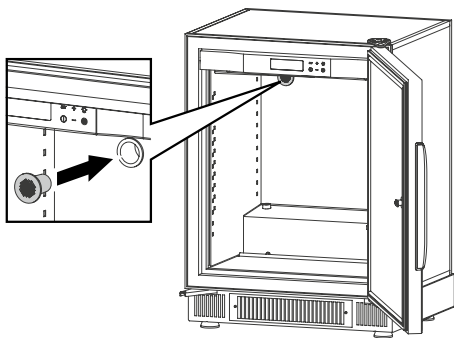

- Adjust the 4 feet of the cabinet (by screwing in or out), so that your wine cabinet stands perfectly level (we recommend using a spirit level).
- Never obstruct the front ventilation grid.
- Take the power lead and connect it to the socket provided at the rear bottom left of the cabinet.

Transport your cabinet to the chosen location.

#### It must:

- away from any heat source
- be open on the outside to allow air to circulate (not a closed cupboard...)
- not be too damp (laundry room utility room, bathroom...),
- have a stable, flat floor,
- have a power supply (standard socket, 16 A, earthed with circuit breaker, 30 mA\* (\*not applicable to some countries).

- For the first use, the carbon filter alarm will be displayed. Reset the filter counter to 365 (see chapter 7, § VI).



**Beware:** any changing of the control panel LED should only be carried out by a qualified electrician.

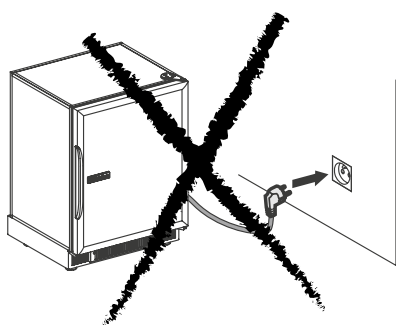

## 4 - INSTALLING YOUR WINE CABINET



### Wall fixing of the cabinet

For large models, if the wine cabinet is not being built in, it is essential to secure it to the wall to prevent it from tipping forward. You will find all the necessary parts in the accessories bag supplied with the unit. For installation (see diagram below):

- 1 Loosen the screws **A**.
- 2 Attach the bracket **B** to the cabinet with the screws **A**.
- 3 Clip the nut **C** to this bracket **B** (preferably choose the hole nearest to the cabinet).



**Warning:** make sure that the part is correctly clipped by pulling upwards by hand. The clip must not come out.

- 4 Preposition the wall bracket **D** (on the nut to determine the position for drilling the holes for the wall-mounting screws,

- 5 Drill the holes then attach the wall bracket **D** with suitable screws **E**.



**Warning:** ensure that the wall fixing can withstand a tensile force of 100 kg.

- 6 Tighten screw **G** with the washer **F** until it is screwed fully in and there is contact between the wall bracket **D** and the nut **C**.

Only full tightening of the screw will ensure correct fixing of the unit. Repeat the installation on the other side of the cabinet.

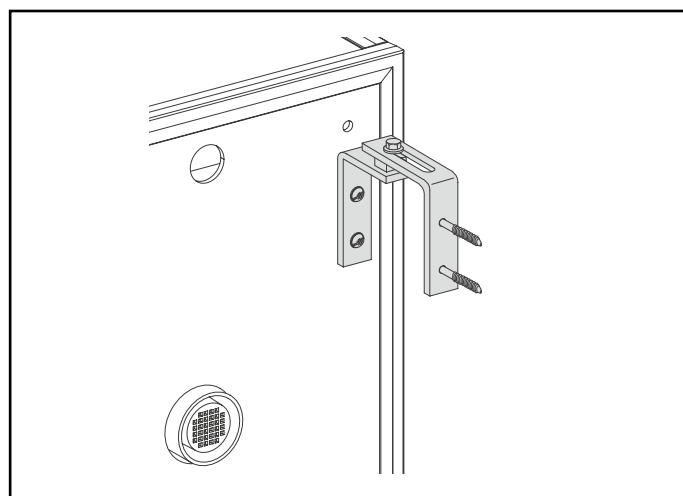
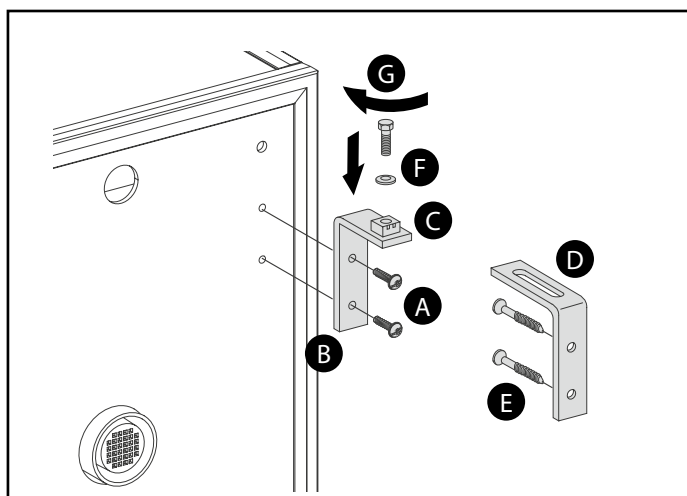

### I. Building in

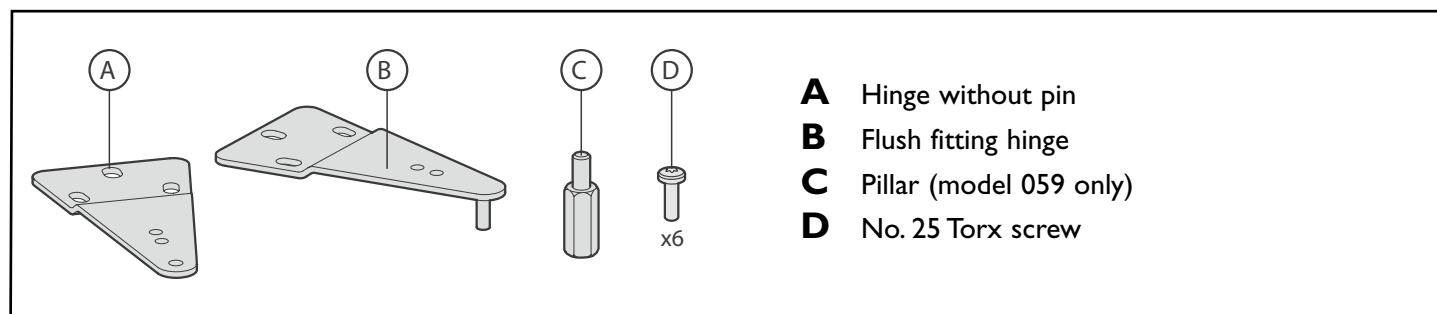

Dimensions for solid, glass or full glass door:

	A maxi	A mini	B		C mini
059	832	816	Solid door	555	821
			Glass door	549	
			Full glass	548	
259	1792	1776	Solid door	572	1781
			Glass door	566	
			Full glass	565	

**259 :** It is essential that the unit inside which the cabinet will be fitted has an opening at the top, at the back, measuring at least 540mm in length and 50mm in width (see technical door diagram).

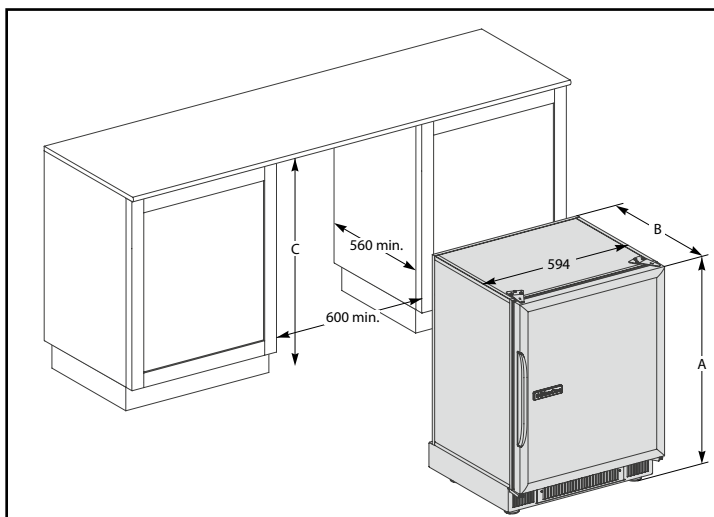



## 4 - INSTALLING YOUR WINE CABINET

Dimensions for a technical door:

	059	259
A maxi	853	1813
A mini	837	1797
B	548	565
C mini	842	1802

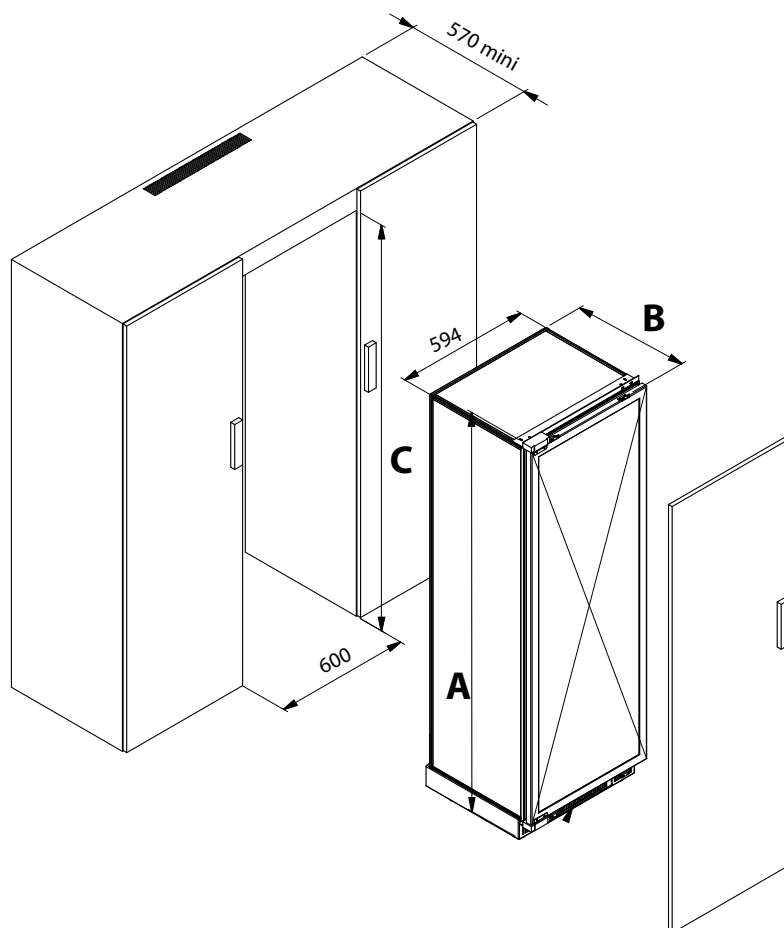

### Changing the hinges

- 1 Loosen the three screws using the Torx "T25" tool.
- 2 Remove the upper hinge.
- 3 Remove the grommets gently using a fine blade.

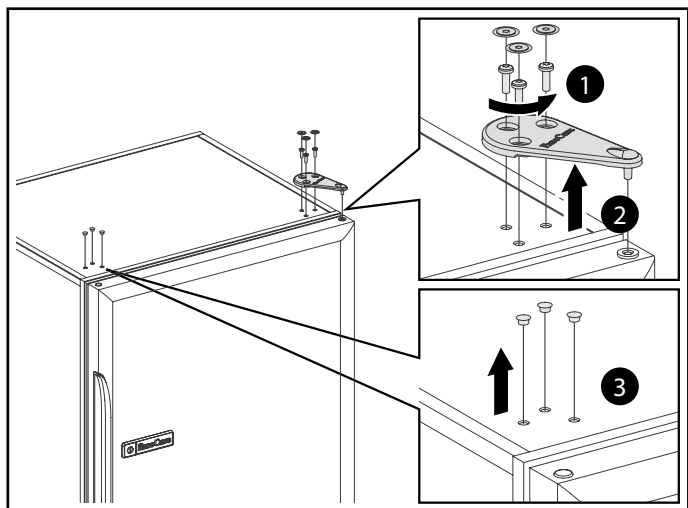

**Precautions:** If you lift off the glass door of the cabinet, never place it on its edges which may cause it to break.

- Fit the hinge with pin **B** using the screws so that the door is parallel to the cabinet.
- Fit the hinge without pin **A** with the screws.

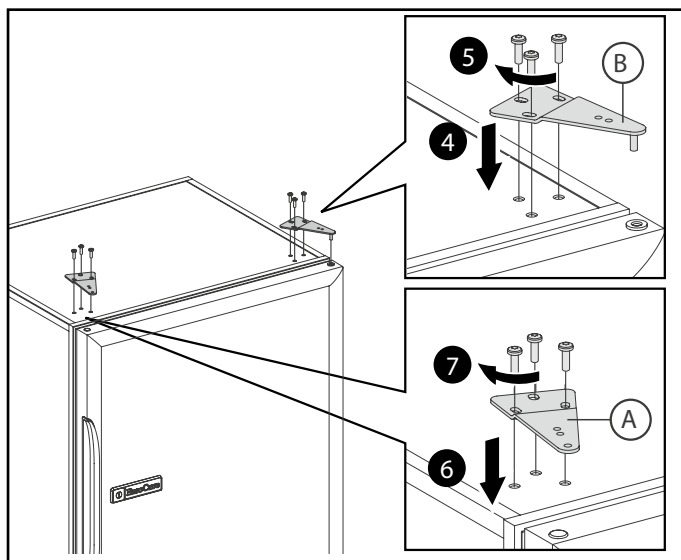

**Precautions:** When closing the door, check that the seal adheres correctly to the cabinet so that it is airtight.



## 4 - INSTALLING YOUR WINE CABINET



### Adjusting the mounting feet and attachment (only when the cabinet is empty)

- The 4 feet of the wine cabinet are adjustable in height so that the height below the work surface or in the unit can be adjusted, and to align the door with adjacent furniture.

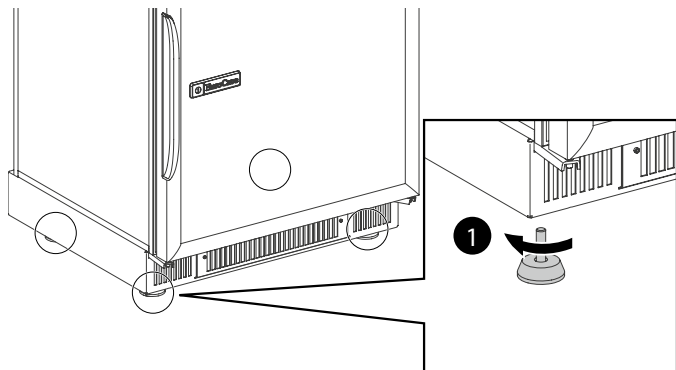

- If necessary, use the hexagonal pillars that you will find in the "accessories" bag.
- Tilt the unit forward, taking care to keep the door closed.
- Unscrew the rear feet and install the pillars, using a 17 mm flat spanner.
- Screw the 2 rear feet back onto the pillars.

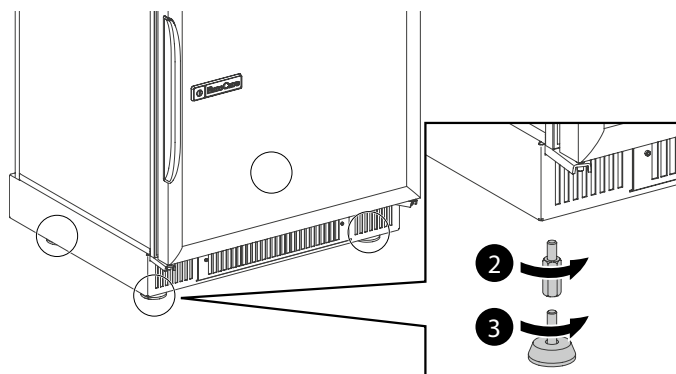

- Repeat these operations for the 2 front feet, taking good care to tilt the unit backwards.

Never obstruct the front ventilation grille which would impair the operation of the wine cabinet

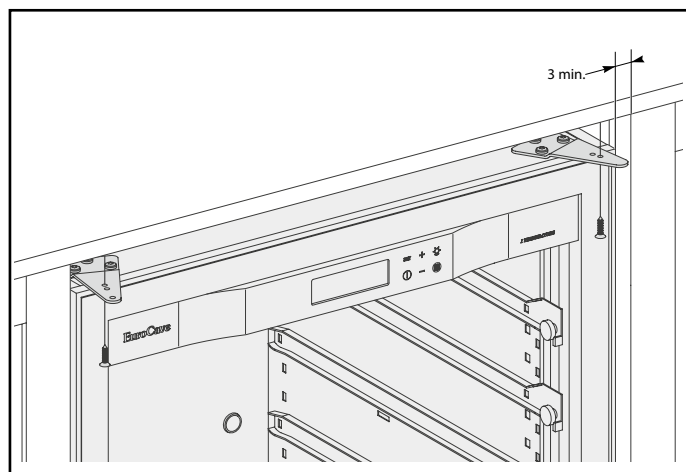

- Use the correct screws to secure the wine cabinet under the work surface or in the unit through the holes provided in the hinges.

**Precautions:** on the side of the axis of rotation of the door, position the latter a minimum of 3 mm from adjacent furniture.



The mains power socket must be accessible after installation of the unit.

For medium and large models, it is **essential** to secure the cabinet to the wall to prevent it from tipping forward. Have your cabinet checked by a professional to confirm that it is fixed to the furniture and that the furniture is fixed to the wall.

### Attachment of a furniture door with a technical door

- Position the cabinet level under the work surface or in the furniture.
- Open the cabinet door 90°.
- Fix the facing of the kitchen furniture to the cabinet door (8 screws supplied).
- Check that the seal is airtight.

### Installing a cabinet within a high level kitchen unit



For safety reasons, we do not advise installing the wine cabinet in a kitchen unit.

If this is the case, check with a furniture specialist that the unit supporting the equipment and the surrounding furniture can support the weight of the cabinet when filled with full bottles, or 200 kg. Have its stability checked by this specialist when opening the door and removing shelves loaded with full bottles.

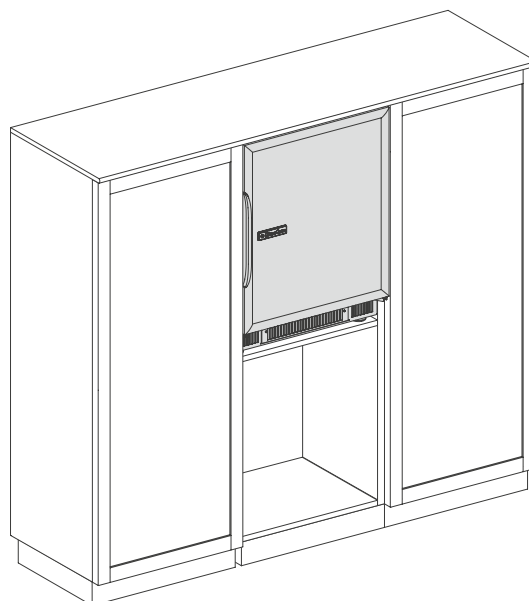



## 4 - INSTALLING YOUR WINE CABINET

### II. Reversibility of the lock

#### To turn the logo round (solid doors only)

- 1** Unscrew the screw with a tool Torx T20 screwdriver.
- 2** Remove the cam.
- 3** Unscrew the nut with a no. 28 spanner (provided in the accessories bag).
- 4** Remove the lock while holding the logo support.

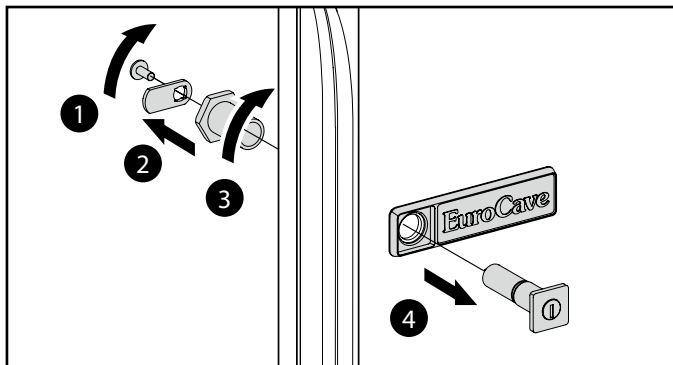

- 5** Taking care, transfer (to the lock side) the logo support.
- 6** Remove the logo support.

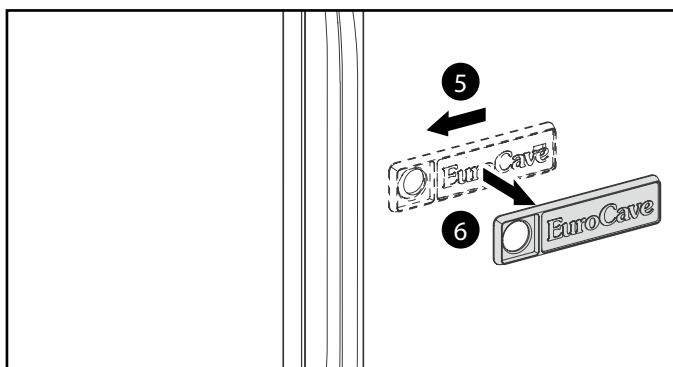

- 7** Gently press the "EuroCave" logo to loosen it from the logo support.
- 8** Rotate the logo 180° before repositioning it on the logo support.

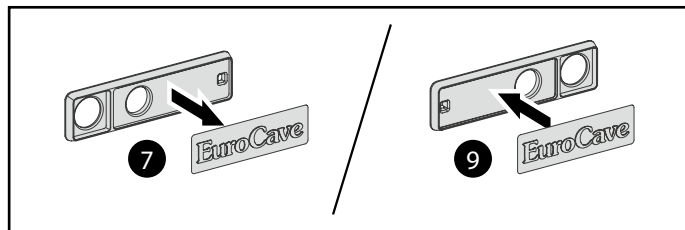

- 9** Replace the logo support
- 10** Replace the lock with the slot vertical and pointing downwards.
- 11** Tighten the plastic nut first by hand as far as possible, then with a 28 spanner (provided in the accessories bag) maximum 1/2 turn of the spanner).
- 12** Attach the cam to the end of the lock with the screw and with a TX20 Torx spanner supplied in the accessories bag.



Place the lock so that the key hole is vertical, and always directed downwards.

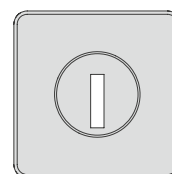
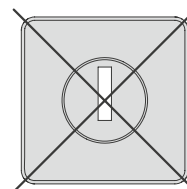
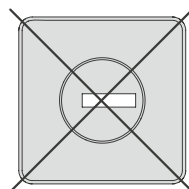



## III. Alternative hanging of a door (solid or glass)

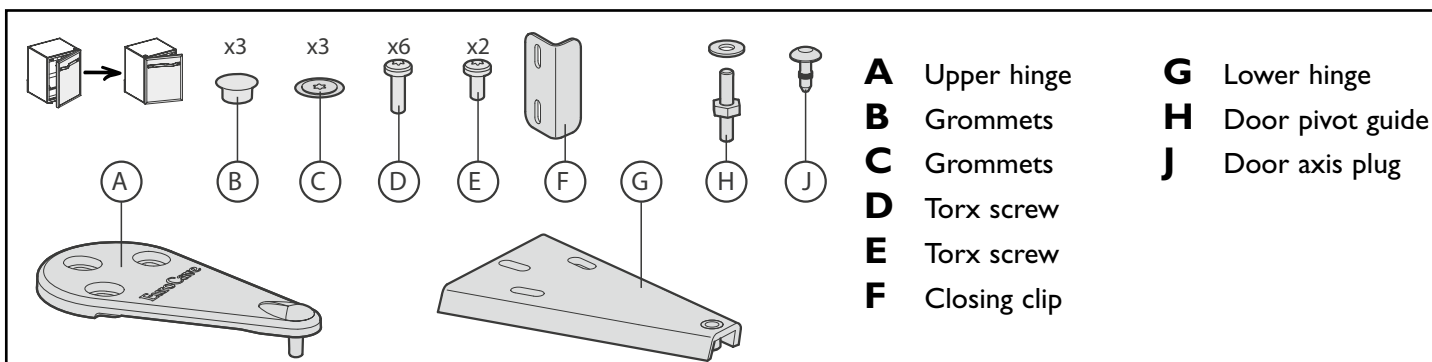

You can change which way it opens. Proceed as follows (example for changing a right hand door to a left hand door):

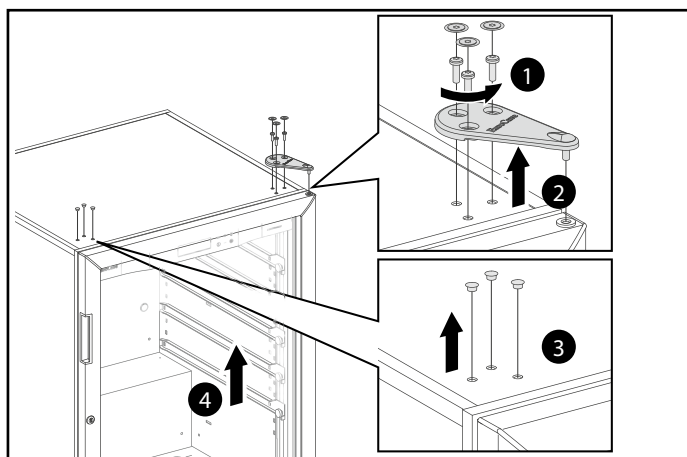

- 1 Loosen the three screws using the Torx "T25" tool.
- 2 Remove the upper hinge.
- 3 Remove the grommets gently using a fine blade.
- 4 Lift the door from the lower hinge by opening the door slightly and then lifting it.

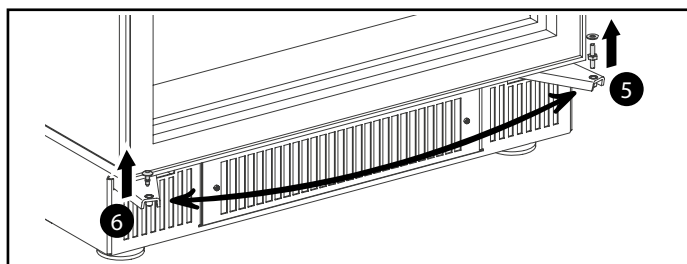

- 5 Loosen the door pivot guide.
- 6 Remove the grommets gently using a fine blade and in its place fit the pin. Relocate the grommet on the opposite side.

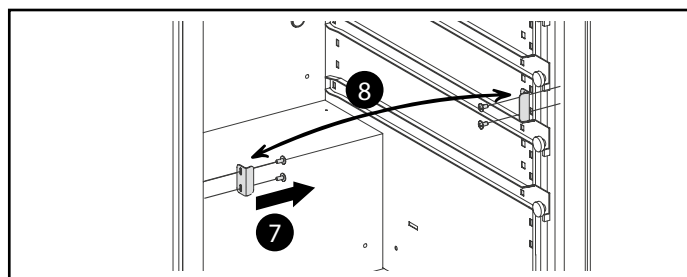

- 7 Loosen the four screws.
- 8 Locate the foot on the other side of the housing using the screws.

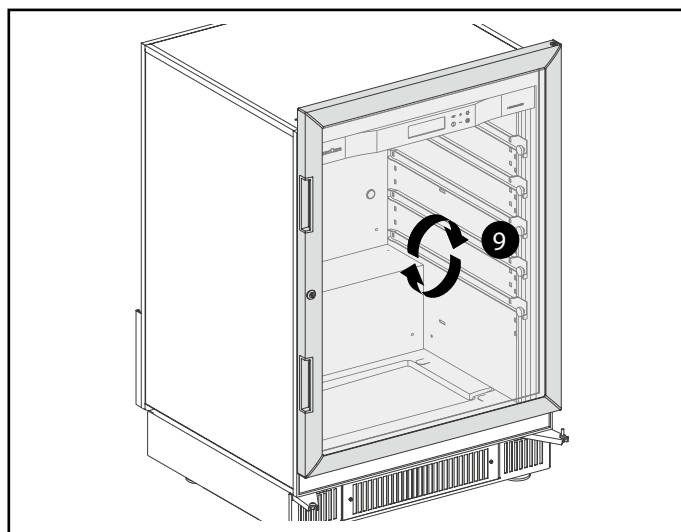

- 9 Turn the door 180°.



**Warning:** the glazed doors are very heavy. Take all necessary precautions not to injure yourself or drop the door.

- 10 Replace the door on its pivot guide.

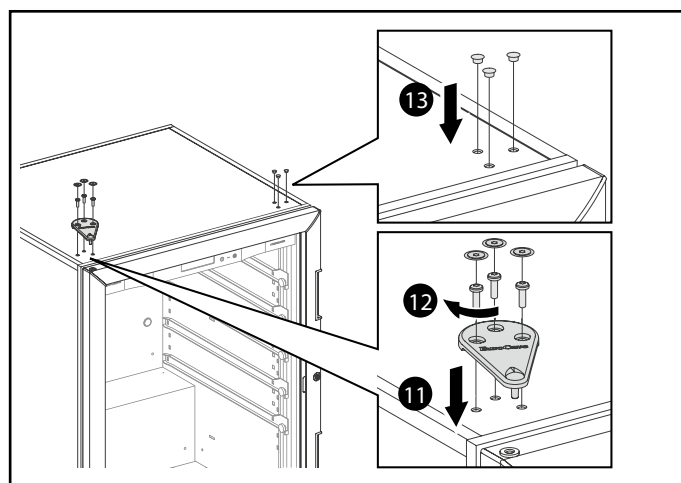

- 11 Relocate the upper hinge.
- 12 Relocate the hinge in such a way so that the door is parallel with the case. Check (by closing the door) that the seal adheres well to the housing and is leak proof.
- 13 Replace the grommets.

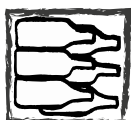

## 5 - ARRANGEMENT - STORAGE

 Your wine cabinet EuroCave has been designed to evolve. Depending on the model, it can be adapted to your requirements and be modified in terms of storage.

### Various storage methods

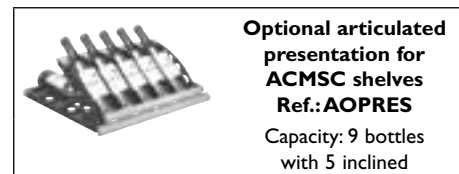
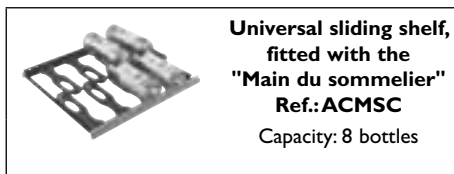

The layout of your wine cabinet can be modified according to your requirements. Refer to pages 72 to 74 to look at arrangement examples.

### How to use the storage shelf (Ref. AXLNH)



To store bottles of **Bordeaux**:  
Turn each metal rod so that it is in contact with the wall of the cabinet. Storage for 4 rows at the front and 5 rows at the back, or 50 bottles\*.

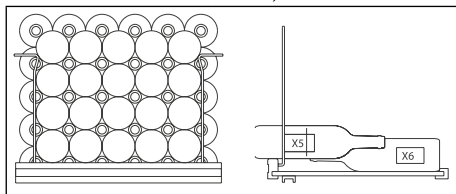

\* Each shelf is fitted with a label holder.

To store bottles of **Burgundy**:  
Remove the metal rods.  
Storage on 7 levels, 8 bottles on each level, or 56 bottles\*.

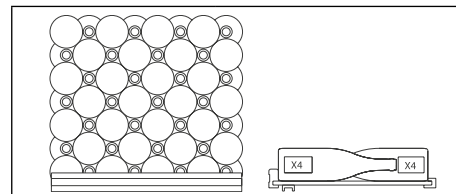

### Advice on arranging your wine cabinet

Your EuroCave wine cabinet has been designed to store a maximum number of bottles in total safety. We recommend that you abide by the following few suggestions in order that the maximum storage capacity can be obtained.

- Make sure that you distribute your bottles as evenly as possible onto the various shelves contained in your cabinet so as to spread the weight equally. Also take care that your bottles do not touch the cabinet's back wall.
- Make sure you distribute your bottles evenly throughout the height of the wine cabinet (avoid loading all bottles at the top or all bottles at the bottom).
- Be sure to observe the storage recommendations in accordance with the type of storage facility provided by your cabinet. Never stack more than one layer of bottles on a sliding shelf.

- If you have sliding shelves, for easy day to day access it is a good idea to place them in the upper part of your wine cabinet.
- **For this reason, place one or two bottles of each of your various wines on the sliding shelves and your reserve stock on the storage shelves. Then all you have to do is top them up as required.**
- **When using your wine cabinet, never pull out more than one sliding shelf at a time.**



**Warning:** Never modify the position of your wine cabinet's bracing bar, and never manoeuvre this part when the cabinet is stocked.

### Adding sliding shelves

When you purchase your wine cabinet, the dimensions of the sliding shelves have been adjusted so that they fit perfectly into the interior of your cabinet. In the event that you purchase another sliding shelf, if necessary, you can adjust it yourself. To do this, loosen the right and left screws ① of the first slider ② (2 screws), then adjust the slide to the width required and retighten the screws. Repeat the procedure for the second slider (if required).

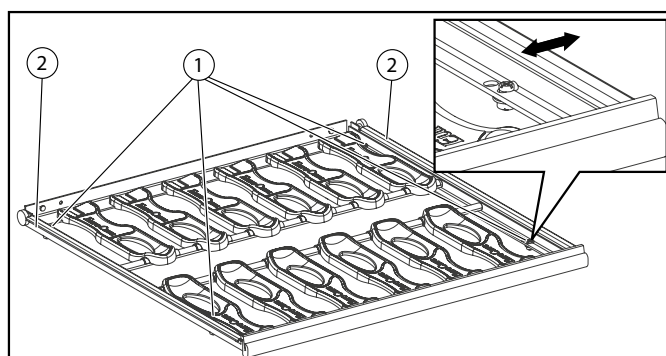

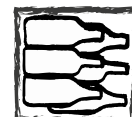

## Change position of a sliding shelf

- Fully unload the sliding shelf.
- Then lift out the sliding tray by sliding it forwards whilst at the same time lifting it from the front.
- Find the runner guides on the left and right and remove.
- Reinstall them in the new position (see diagram below).

### A. Setting up the rear part of the guide

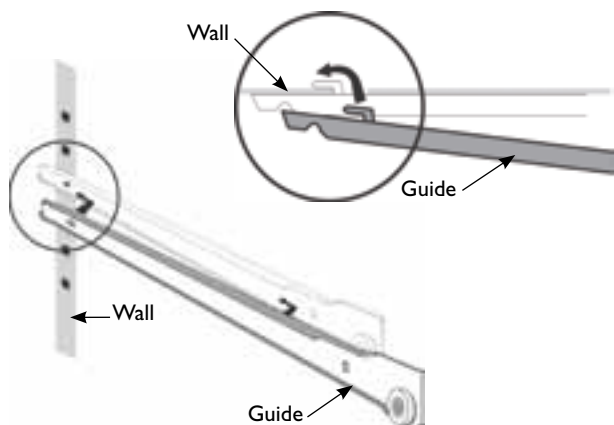

### B. Setting up the front part of the guide

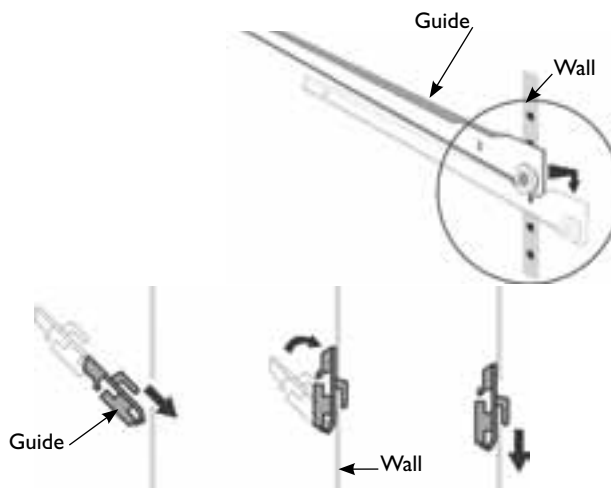

### C. Then replace the sliding shelf

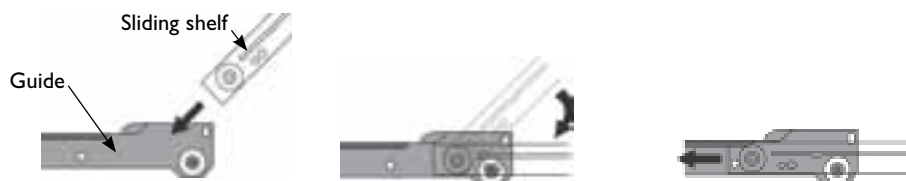



## 6 - COMMISSIONING YOUR WINE CABINET

### I. Connection and starting up

Wait 48 hours before plugging in your wine cabinet.

To switch it on, press and hold down button **I** for 5 seconds.



Have your plug checked (presence of fuses, amps and 30 mA circuit breaker).

Do not plug several cabinet into a multi-socket.



To ensure that your cabinet functions optimally, we recommend that you fill it to at least 75 % of its capacity.

#### Check your type of wine cabinet

Press the **+** and **-** keys simultaneously.



### II-A. Description (I-temperature model V059 - V259)

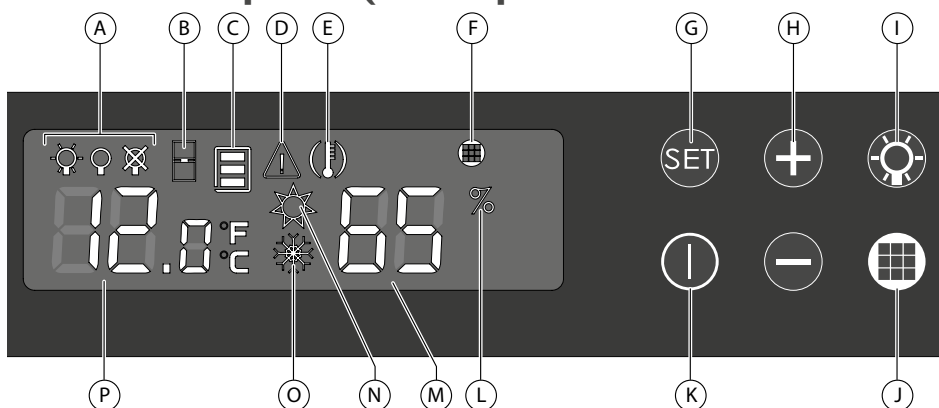

The touch keys are very sensitive. There is no need to push the keys very hard. A simple, gentle touch is enough to register the setting. Think to lift your finger from the control panel between each touch.

**A** Lighting mode

**B** Door open alarm

**C** Temperature zone

**D** Fault sensor alarm

**E** Temperature alarm

**F** Carbon filter alarm

**G** Validation and settings access button

**H** Selection and adjustment buttons

**I** Lighting mode validation and access button

**J** Carbon filter counter log access button

**K** Power button

**L** Threshold humidity alarm

**M** Relative humidity level display

**N** Hot circuit indicator light

**O** Cold circuit indicator light

**P** Temperatures display

### III-A. Temperature settings

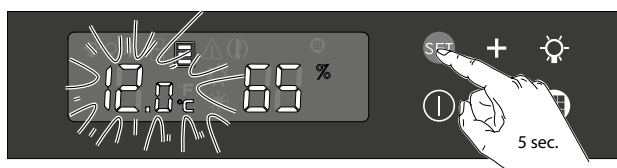

Press the **I** key for 5 s to activate.

**1** Press the **SET** key about 5 s.

The display starts to flash.

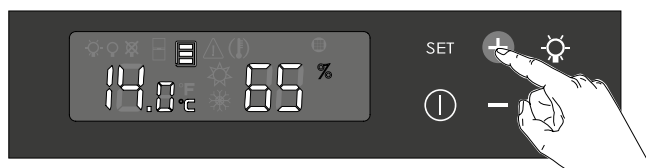

**2** Press the **+** or **-** keys to set the desired temperature.

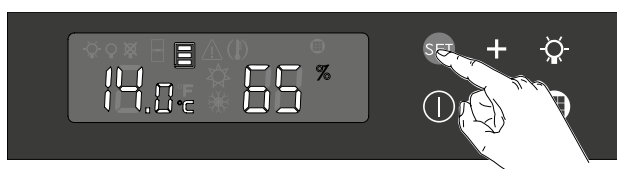

**3** Press the **SET** button to validate.



The value on the display is the actual temperature inside the cabinet, it is therefore necessary to wait before your new setting takes effect.

- The default setting is 12 °C/54 °F (ideal maturing temperature). However, this setting can be adjusted between 5 and 22 °C (41° and 72°F).
- Recommended maturing setting range: 10 to 14 °C (50° to 57 °F).

**WARNING:** to operate correctly your cabinet should be located in a room with a temperature between 0° and 35 °C (32° and 95 °F).



Converting your maturing cabinet into a service cabinet: you can use your I-temperature maturing cabinet as a service cabinet in order to bring your white and red wine to tasting temperature (setting range between 5° to 22 °C/41° to 72 °F):

- white wines: recommended setting between 6° to 10 °C (43° to 50 °F)
- red wines: recommended setting between 15° to 18 °C (59° to 64 °F).

This cabinet can therefore be used as a specific white or red wine service cabinet.





## II-B. Description (multi-temperatures model S059 - S259)

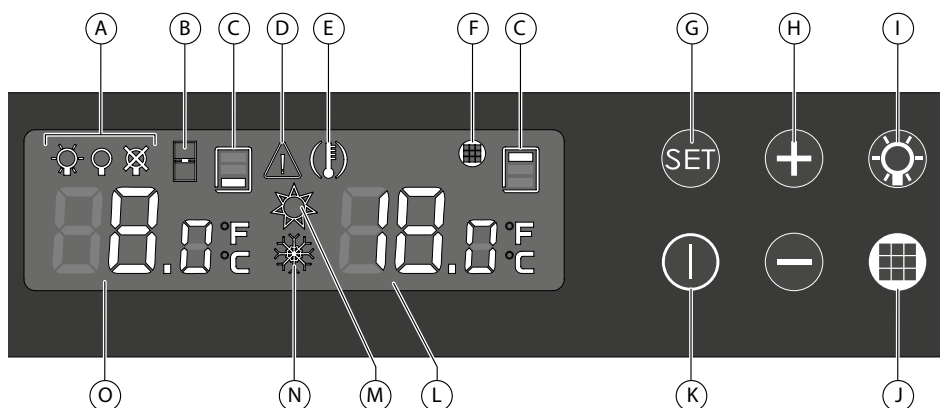

The touch keys are very sensitive. There is no need to push the keys very hard. A simple, gentle touch is enough to register the setting. Think to lift your finger from the control panel between each touch.

- A** Lighting mode
- B** Door open alarm
- C** Temperature zone concerned
- D** Fault sensor alarm
- E** Temperature alarm
- F** Carbon filter alarm
- G** Validation and settings access button
- H** Selection and adjustment buttons
- I** Lighting mode validation and access button
- J** Carbon filter counter log access button
- K** Power button
- L** Highest cabinet temperature display
- M** Hot circuit indicator light
- N** Cold circuit indicator light
- O** Lowest cabinet temperature display

## III-B. Temperature settings

**Recommended setting range for the lowest temperature: 7 to 9 °C (45° to 48 °F).**

**Recommended setting range for the highest temperature: 17 to 20 °C (62° to 68 °F).**



Press the **I** key for 5 s to activate.

- 1** Press the **SET** key about 5 s.  
The display starts to flash.

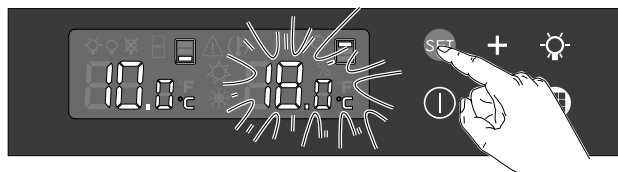

- 3** Press the **SET** button to validate.  
The right-hand display is flashing.

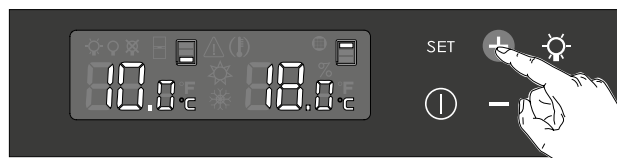

- 2** Press the **+** or **-** keys to set the temperature of the lower section of the cabinet.



- 4** Press the **+** or **-** keys set the temperature of the upper section of the cabinet
- 5** Press the **SET** button to validate.



The value on the display is the actual temperature inside the cabinet, it is therefore necessary to wait before your new setting takes effect.

- The default setting for the lowest temperature range is 8 °C (46 °F). However, this setting can be adjusted between 5 and 12 °C (41° and 54 °F).
- The default setting for the highest temperature range is 18 °C (64 °F). However, this setting can be adjusted between 15 and 22 °C (59° and 72 °F).

**WARNING:** to operate correctly your cabinet should be located in a room with a temperature between 12 and 35 °C (54° and 95 °F).



## 6 - COMMISSIONING YOUR WINE CABINET

### IV. Humidity level display

Your wine cabinet is fitted with a function for measuring the level of hygrometry, enabling you to visualise the level of relative humidity inside your apparatus.

The ideal level of hygrometry is above 50 %, ideally located between 60 and 75 %.

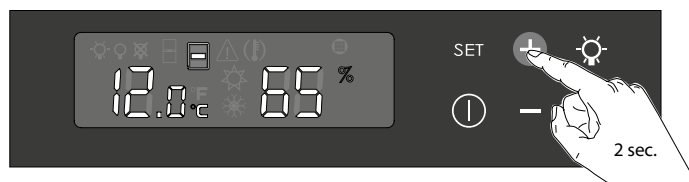

If you would like to increase the level of relative humidity in your cabinet, pour the equivalent of a glass of water on the humidity cassette. You need to remove the bottles before.

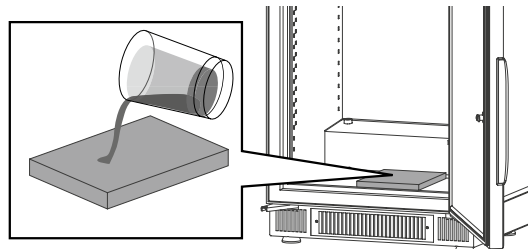

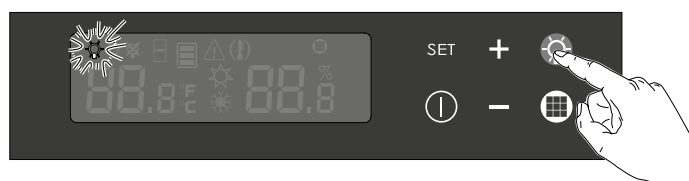

### V. Lighting mode adjustment





- 1 Press the  button.  
The active mode light flashes.

There are 3 possible lighting settings:

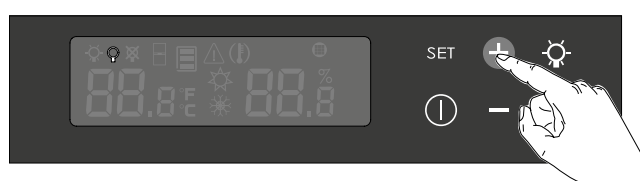
-  Lighting all the time (for mood lighting when using a glass door cabinet, for example).
-  Lighting when door opens (it goes out when the door is closed).
-  Lighting disabled.



- 2 Press the  or  keys to set the desired mode.
- 3 Press the  button to validate.  
The alarm display goes out.



**Usage precautions:** intense light, never look directly into the beam.

### VI. Carbon filter counter log display

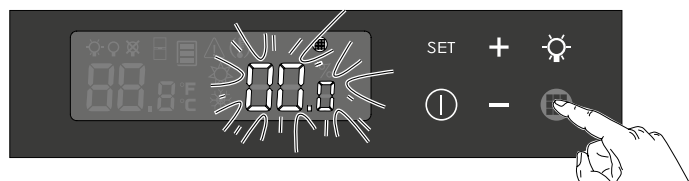

When activating or replacing the filter, adjust the counter to 365.

- 1 Press the  key.  
The display is flashing.



- 3 Press the  button to validate.  
The alarm display goes out.



- 2 Press the  key to adjust to 365.



The carbon filter must be changed annually.



You can consult the counter by pressing the  key.



In a particularly dry environment and/or in climatic conditions that are not very favourable (e.g. winter), you can use the "Hygro+" humidity kit which allows you to increase the level of humidity inside your wine cabinet.

## 7 - EVERYDAY MAINTENANCE



Your EuroCave wine cabinet is an appliance with tried and tested performance.

### Maintenance operations to be carried out every 3 months

- Remove the 2 screws from the grille with a no. 2 hexagonal spanner (provided in the accessories bag).
- Remove the grille, take out the filter and place under running water.
- Leave to dry and refit the assembly.

### Maintenance operations to be carried out approximately once a year

- Unplug and unload the appliance.
- Clean the water drain at the bottom of the wine cabinet. Pay attention that nothing is blocking this drain.
- Clean the inside of the compartments with water and a gentle cleaning product.
- Rinse thoroughly. Dry it with a soft rag.
- Replace the active carbon filter housed in the upper ventilation hole in your cabinet (see chapter 5). Manually remove the carbon filter. It is available from your usual dealer. It must be replaced using a manufacturer guaranteed part.
- Check that the door seals are in good condition. It is often necessary to clean the door seal. Using unsuitable cleaning products can cause premature ageing of the seals. Certain rules must therefore be followed: whenever you clean the seal, always rinse off any cleaning product with clear water. All traces of cleaning product must be removed from the seal. EuroCave only recommends using a mild soapy solution. If this proves insufficient, it is possible to occasionally use an ethanol-based solution, provided that the concentration used is less than 10% and that the seal is then rinsed thoroughly with clear water.

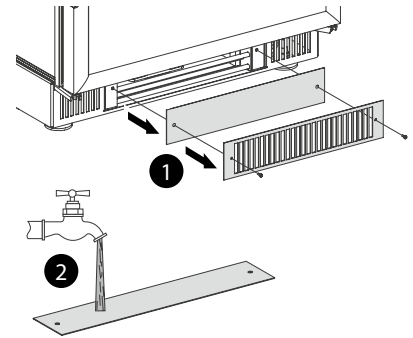







Monitoring your wine cabinet's performance and informing your stockist if a fault occurs are the best way of ensuring that your appliance provides you with years of faithful service.



Your appliance is equipped with a frost prevention device to protect you in the event of a cold circuit failure.

## 8 - OPERATING FAULTS



Possible incidents	Causes	Corrective action
The icon  displays	The temperature has not dropped below the limit of $\pm 4^{\circ}\text{C}$ / $39^{\circ}\text{F}$	Check the door is closed properly. Check the condition of the door hinge. If you have placed a large number of bottles in your cabinet in the past few hours, wait a short while then check the temperature again.. If the alarm persists, contact your EuroCave dealer.
The icon  is still displayed even though I have performed the corrective action above	Operating faults	Disconnect the cabinet and contact your EuroCave dealer.
The icon  displays	Open door alarm	Ensure the door is closed properly.
The icon  flashes	The relative humidity rate falls below 65 % for more than 72 hours	<ul style="list-style-type: none"> <li>• Add a glass of water on the humidity cassette (see chapter 7, § IV).</li> <li>• In order to obtain the time interval for adding water, count the number of days between the 1st day when water was added and the day when the pictogram was displayed.</li> </ul> After a few hours the icon will go out.
The apparatus cannot lower the humidity to the desired level.		<ul style="list-style-type: none"> <li>• Empty the cabinet, remove the humidity cassette and clean the tank.</li> <li>• Remove the tube positioned on the bottom of the tank. The humidity will be directly removed from the apparatus.</li> <li>• Adjust the level of humidity to 75 % but do not install the pozzolana cassettes or replace them with new ones.</li> </ul> Call the EuroCave dealer if the problem persists despite these different actions.
The icon  displays	Carbon filter alarm	Replace the carbon filter (see chapter 5).
The icon  displays	Temperature sensor defect alarm	Contact your EuroCave dealer.



If your appliance appears to be functioning abnormally, contact your EuroCave dealer.

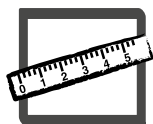

## 9 - ENERGY AND TECHNICAL FEATURES

### Compact 59

	Height mm	Width mm	Depth mm	Weight when empty kg	Recommended temperature range	
					T° min (°C / °F)	T° max (°C / °F)
I temperature						
V059	830	595	570	42	0 / 32	35 / 95
V259	1790	595	585	65	0 / 32	35 / 95
Multi-temperatures						
S059	830	595	570	40	12 / 54	30 / 86
S259	1790	595	585	63	12 / 54	30 / 86

Setting accuracy: +/-1°C/ 2°F, Display accuracy: +/- 1 °C/ 2 °F.



The use of glass doors can alter the performance of your wine cabinet in some extreme temperature conditions.

## Technical features and data relating to European regulations on power consumption

Reference	Type of door	Energy efficiency rating <sup>1</sup>	Annual energy consumption AEC (kWh/year) <sup>2</sup>		Useful volume (liters)	Temperature of the other compartments <sup>3</sup>	Acoustic emissions (dB(A))	
			230V-50Hz (R600a gas)	115V-60Hz (R134a gas)			230V-50Hz (R600a gas)	115V-60Hz (R134a gas)
I temperature								
V-059V2	Solid door	B	165	285	111	-	42	42
V-059V2	Glass door	C	219	383	111	-	42	42
V-059V2	Technical door	C	201	334	111	-	42	42
V-259V2	Solid door	B	201	321	318	-	37	42
V-259V2	Glass door	C	274	456	318	-	37	42
V-259V2	Technical door	C	238	389	318	-	37	42
Multi-temperatures								
S-059V2	Solid door	B	194	256	119	-	42	42
S-059V2	Glass door	C	249	347	119	-	42	42
S-059V2	Technical door	C	230	301	119	-	42	42
S-259V2	Solid door	B	201	292	325	-	37	42
S-259V2	Glass door	C	274	402	325	-	37	42
S-259V2	Technical door	C	238	347	325	-	37	42

1- Only concerns 230V-50Hz models (R600a gas).

2- Power consumption calculation based on the result obtained over 24 hrs in standard test conditions (25°C/77°F). Actual power consumption depends on the appliance's location and operating conditions.

This appliance is intended exclusively for wine storage.

Category of all models: 2

Climate class: Our appliances are designed for use at an ambient temperature of between 10°C and 32°C (50°F and 90°F) (Class SN). Nevertheless, refer to the technical properties tables for the optimal performance levels of your product.

These appliances cannot be built-in.

3- red serving temperature

### Standards

Your product complies with the following standards:

**1- SAFETY** - Directive 2006/95/CE

Standards EN60335-1:Version 5 - 2010 +A1 + A2 + A11 + A12 + A13

EN60335-2-24:Version 7 - 2010 + A1 + A2 + A11

**2- EMC** - Directive 2004/108/CE

Standard EN55014-1/2

**3- ENVIRONMENT** - Directive 2010/30/EU

Regulation 1060/2010



### R600a

Depending on the country, EuroCave wine cabinets may contain flammable refrigerant gas (R600a: ISO BUTANE).