

Mode	d'emploi	-	Gamme	Première	
User	Manual	-	Première	Range	
Gebrauchsanweisung		-	Reihe	Première	
Modo	de	empleo	-	Gama	Première
Gebruiksaanwijzing			-		Première-lijn



EUROCAVE 

Des solutions adaptées à tous vos besoins - Solutions to meet all your needs
 All Ihren Bedürfnissen angepaßte Lösungen - Soluciones adaptadas a todas sus necesidades
 Oplossingen aangepast aan uw behoeften - Soluzioni adatte a tutte le vostre esigenze

EUROCAVE - CAVES À VIN - WINE CABINETS - WEINKLIMASCHRÄNKE - ARMARIOS PARA VINOS - WIJNKASTEN - CANTINETTE PER VINI



Compact



Pure



Revelation



Collection



Tête à Tête



Cuir - Leather



Elite - Caves à Cigares / Cigar Humidor



Wine Art

**EUROCAVE - SYSTÈMES DE RANGEMENT - STORAGE SYSTEMS - REGALSYSTEME
 SISTEMAS DE COLOCACIÓN - ÖPBERGSYSTEMEN - SISTEMI DI STOCCAGGIO**

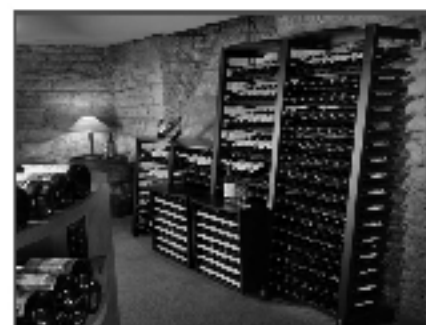

Modulosteel



Modulothèque



Modulorack - Inox®

**GAMME EUROCAVE PROFESSIONAL - EUROCAVE PROFESSIONAL RANGE
 REIHE EUROCAVE PROFESSIONAL - GAMA EUROCAVE PROFESSIONAL
 EUROCAVE PROFESSIONAL-LIJN - GAMMA EUROCAVE PROFESSIONAL**



Gamme 5000



ShowCave



Vin au Verre®



Wine Bar®

WELCOME

You have just purchased a EuroCave product – thank you for your custom.
We take particular care in manufacturing our products in terms of their design, ergonomics and ease of use.
We hope that you will be completely satisfied with this product.

GB

PLEASE NOTE

The information contained in this document may be changed without warning.
EuroCave offers no guarantee for this appliance when it is used for purposes other than those for which it was designed.
EuroCave shall not be held responsible for any errors contained in this manual or for any damage linked to or resulting from the supply, performance or use of this appliance.
This document contains original information, which is protected by copyright. All rights are reserved. Photocopying, reproducing or translating this document, whether partially or completely, is strictly forbidden, without EuroCave's prior written consent.
This appliance is intended solely for storing wine.
It is not designed to be used by people (including children) with reduced mental, sensorial or physical abilities, or by people who have no experience or knowledge, unless they have first received instructions on how to use the machine or are supervised by a person responsible for their safety.
Children must be supervised to ensure that they do not play with the appliance.
If the power lead is damaged, it must be replaced by a special cable or unit available from the manufacturer or its customer service department.

WARNING:

- Ensure that the air vents in the appliance's cavity and the flush-fitting structure are unobstructed.
- Do not use mechanical devices or other means to speed up the defrosting process other than those recommended by the manufacturer.
- Do not damage the refrigeration circuit.
- Do not use electrical appliances inside the wine storage compartment, unless they have been recommended by the manufacturer.
- Do not store in this appliance explosive substances such as aerosols containing flammable propellant gas.

This appliance is intended for domestic and similar applications such as:

- kitchenettes reserved for staff of shops, offices and other professional environments;
- gites and use by guests of hotels, motels and other environments which are residential in nature
- hotel rooms;
- the food service industry and other similar applications except for retail sale.

There is a name plate inside the cabinet. The name plate provides various technical information and safety notice with a yellow flame triangle label, name and chemical symbol of the refrigerant.

The refrigerator contains flammable refrigerant (R600a: iso-butane). Requirements to ensure gas safety and safe use of refrigerators: The refrigerator system behind and inside the refrigerator contains refrigerant. Do not allow any sharp objects must come into contact with the refrigeration system.

- Do not use electrical appliances inside the wine cabinet.

Children should be supervised to ensure that the refrigerator should be used properly.

Do not use the mechanical devices or other means to accelerate the defrosting process, unless they are of the type recommended by the manufacturer.

Do not block the openings on the circumstances of the refrigerator.

- In case of having damaged the refrigerant circuit, do not use electric items or fire equipments nearby, and open all the windows to provide good ventilation. Please also contact your local maintenance agent to follow up
- Do not remove the bottom grill of the cabinet unless it is recommended by the manufacturer. Do not place directly the wine bottles without the grill.

-DANGER: Risk of child entrapment. Before you throw away your old wine cabinet:

- Take off the doors
- Leave the shelves in place so that children may not easily climb inside.

-The use of an extension cord is not recommended.

The warning labels mentioned above should be kept throughout the life of the refrigerator. The user manual should be handed over to any person who would use or handle the refrigerator whenever the refrigerator would be transferred to another location and delivered to a recycling plant;

WELCOME TO THE WORLD OF EUROCAVE

Our priority is helping you to find the best solutions for your wine storage needs...To do so, EuroCave has drawn on its considerable expertise to combine the 6 essential criteria for serving wine:

Temperature

The two enemies of wine are extreme temperatures and sudden fluctuations in temperature. A constant temperature allows wine to reach its full potential.

Humidity

It is an important factor, allowing the corks to retain their sealing qualities. The level of humidity must be above 50% (ideally between 60 and 75%).

Protection from light

Light, particularly its ultraviolet component, causes wine to deteriorate very quickly by irreversible oxidation of tannins. It is therefore strongly recommended that you store your wine in a place protected from U.V. light.

Lack of vibration

Vibration disturbs wine's long development process and is often fatal for your finest wines. The "Main Du Sommelier" supports adapt to the shape of the bottle and protect it from vibration (anti-vibration technology).

Circulation of air

A constant supply of fresh air prevents mould from developing in your cabinet. EuroCave cabinets benefit from a ventilation system by breather effect, which makes it very similar to the ventilation system found in a natural cellar.

Storage

Moving bottles around too often is harmful to your wine. Having suitable shelving which limits handling is essential.

Thank you for placing your trust in EuroCave.

Standard temperatures for serving wine

French wines

Alsace	10 °C
Beaujolais	13 °C
Sweet White Bordeaux	6 °C
Dry White Bordeaux	8 °C
Bordeaux Reds	17 °C
Burgundy Whites	11 °C
Burgundy Reds	18 °C
Champagne	6 °C
Jura	10 °C
Languedoc-Roussillon	13 °C
Provence Rosé	12 °C
Savoie	9 °C
Dry White Loire Wines	10 °C
Sweet White Loire Wines	7 °C
Loire Reds	14 °C
Rhône wines	15 °C
Sweet Wines from the South-West	7 °C
Reds from the South-West	15 °C

Australian wines

Cabernet franc	16 °C
Cabernet sauvignon	17 °C
Chardonnay	10 °C
Merlot	17 °C
Muscat à petit grain	6 °C
Pinot noir	15 °C
Sauvignon blanc	8 °C
Semillon	8 °C
Shiraz	18 °C
Verdhelo	7 °C

Other wines

California	16 °C
Chile	15 °C
Spain	17 °C
Italy	16 °C

CONTENTS



1 - Description of your wine cabinet

6

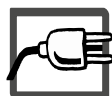

2 - Power supply

7



3- Protecting the environment and saving energy

7



4 - Installing your wine cabinet

7-10

I - Door reversibility

9



5 - Layout – Storage

10-11

Adding or changing the position of a sliding shelf

11



6 - Commissioning your wine cabinet

12

I Connection and powering up

12

II Description (I temperature model V-PREM-S, V-PREM-M, V-PREM-L)

12

III Temperature setting

12



7 - Everyday maintenance

13



8 - Operating faults

13



9 - Energy and technical features

14



10 - Storage simulation

111-112



I - DESCRIPTION OF YOUR WINE CABINET

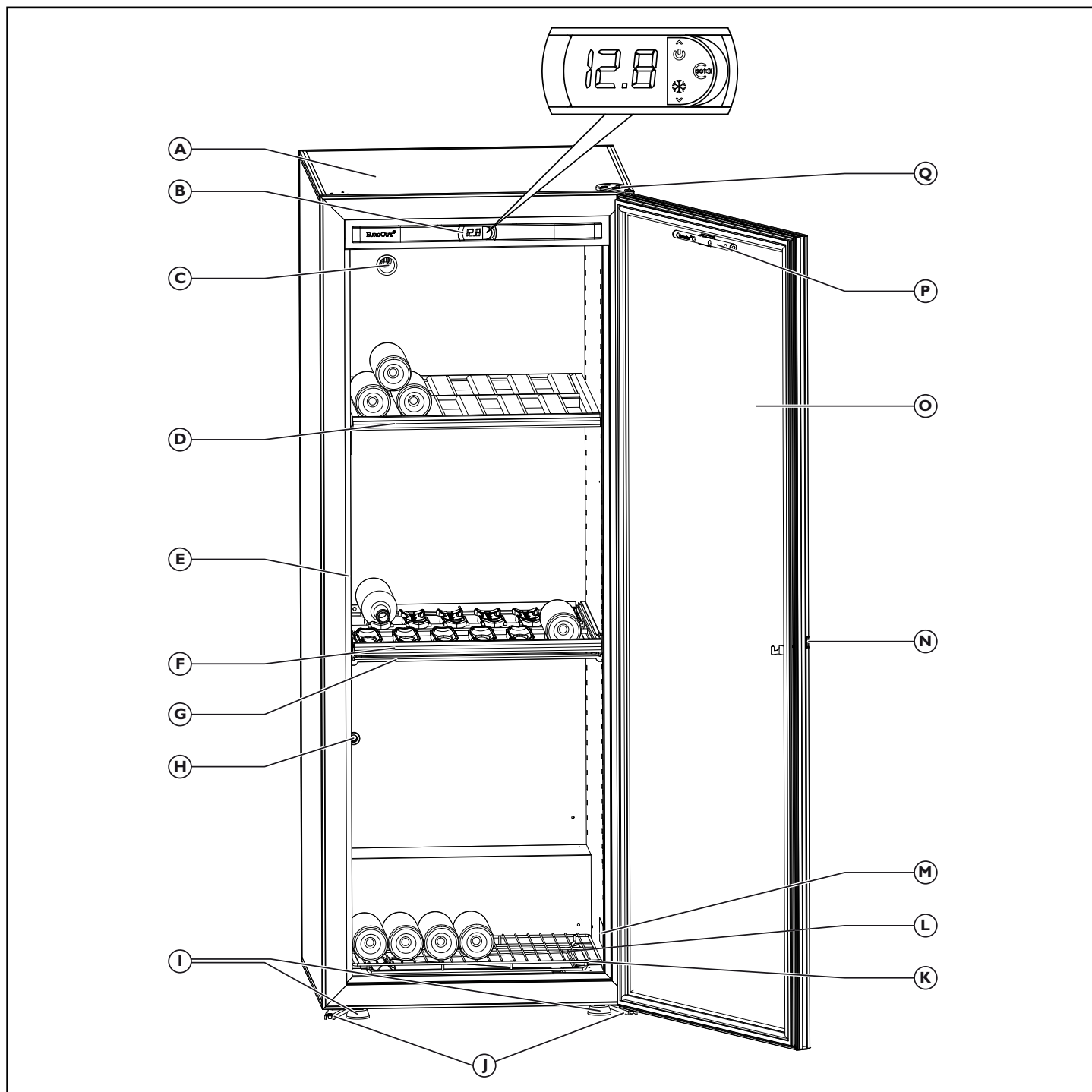

- | | |
|---|--|
| A Cabinet body | K Grill |
| B Setting and control panel | L Condensate collection tray with outlet hole |
| C Breather hole + Active charcoal filter | M Product identification label |
| D Storage shelf | N Dual-action lock |
| E Door catch | O Door (including a handle built into the side of the door) |
| F Sliding shelf | P Removable lighting system (4 LED, adhesive base) |
| G Cabinet stiffener (do not remove) - large model only | Q Upper hinge |
| H Fresh air vent | |
| I 2 adjustable feet for levelling | |
| J Lower hinge (x2) | |

2 - POWER SUPPLY



The wine cabinet's power lead has a plug, to be plugged into a standard earthed outlet to prevent any risk of electric shock.



For your personal safety, the wine cabinet must be correctly earthed. Ensure that the socket is correctly earthed and that your installation is protected by a circuit breaker (30 mA*)
*Not applicable to some countries.



Have the power supply socket checked by a qualified electrician who will check that it is correctly earthed and will carry out, if necessary, work to ensure that the socket complies with current standards.

Contact your usual EuroCave retailer to change the power lead if it is damaged. It must be replaced by a EuroCave original manufacturer's part.



If you are moving to a foreign country, check that the supply characteristics of the cabinet correspond to the country (voltage, frequency).

3 - PROTECTING THE ENVIRONMENT AND SAVING ENERGY



Disposal of packaging

All packaging used by EuroCave is made from recyclable materials.

After unpacking your cabinet, take the packaging to a refuse collection point. For the most part, it will be recycled.

Recycling: a caring gesture

Electrical and electronic equipment can have a harmful effect on the environment and human health owing to the presence of hazardous substances.

You should never therefore trash electronic and electrical equipment with unsorted municipal waste.

When purchasing a new EuroCave product, you can entrust recycling of your old appliance to your EuroCave retailer.

Speak to your EuroCave retailer. He will explain the removal and collection arrangements set up in the EuroCave network.

In compliance with legislation relating to protecting and caring for the environment, your wine cabinet does not contain C.F.C.s or H.C.F.C.s.

To save energy

- Install your wine cabinet in a suitable location (see following page) and observe the recommended temperature ranges.

- Keep the door open for as short a time as possible.

- Ensure that the door seal is in good working order and that it is not damaged. If it is, contact your EuroCave retailer.

Disable any unusable appliances by unplugging them and cutting off the power lead.

4 - INSTALLING YOUR WINE CABINET



Unpacking

- When your cabinet is delivered, check the outside for signs of damage (impact, warping...).
- Open the door and check that the various elements inside are intact (walls, Main du Sommelier supports, hinges, bottle support...).
- Remove the protective elements found inside and outside your cabinet including the lower hinge protector (see diagram (1))
- Fit the cap (see diagram 2), found in the accessories bag, used for sealing the hole in the lower hinge.

If there is a problem, contact your EuroCave retailer.

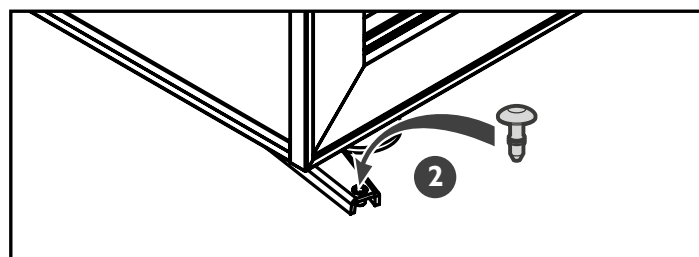
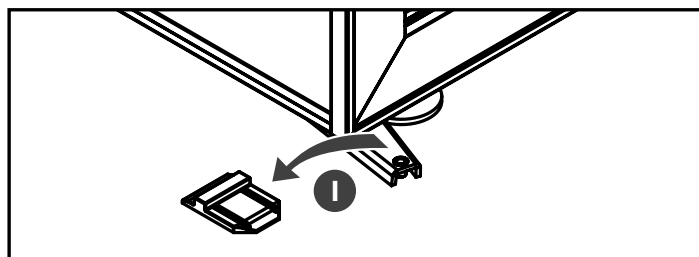



4 - INSTALLING YOUR WINE CABINET

Precautions

- Do not place your cabinet in an area liable to flood.
- Do not place your cabinet close to a source of heat or expose it to direct sunlight
- Prevent water from splashing on any parts of the rear of the machine.
- Arrange the power lead so that it is accessible and does not come into contact with any of the appliance's components.
- Tilt the cabinet slightly backwards in order to adjust the front feet (by screwing or unscrewing them) so that you can level your cabinet (spirit level recommended).
- Install the stop (which is located in the accessories bag) at the back of the cabinet (see diagram).
- This allows a space of 7 cm to be maintained between the wall and the rear of the cabinet. This space allows your cabinet's power consumption to be optimised.
- Place the 2 caps in the 2 holes at the top of the cabinet.
- Do not push the caps all the way in, in order to allow the rear stop to be installed.
- Slide the rear stop between the caps and the wall of the cabinet, then push the 2 caps all the way in.

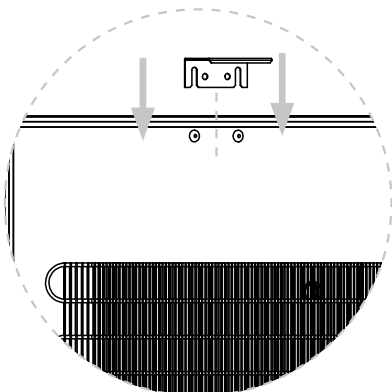

Installation

Place your cabinet in the desired location.

It must:

- be open to the outside and well ventilated (not in an enclosed cupboard, for example),
- not be too damp (utility room, laundry room, bathroom...),
- have a flat, stable floor,
- be supplied with power (standard outlet, 16 A, earthed with 30mA* circuit breaker). (* not applicable to some countries).



When moving your cabinet, never tilt it more than 45°, and always on its side (on the opposite side of the flexible lead).

- Place your cabinet in the desired location.
- Fit the charcoal filter (located in the "accessories" bag) by inserting it into the breather hole located on the top left-hand side of the inside of your cabinet (see diagram below).

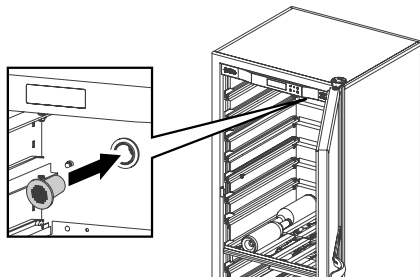

- Take the lead and plug it into the connector, located at the back of the cabinet, on the bottom left-hand side.
- Wait 48hrs before plugging in your cabinet.

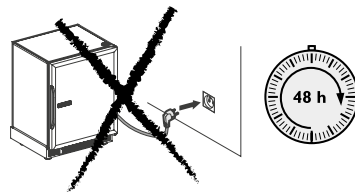

Bottles must be arranged so that they do not come into contact with the back wall. If this happens, the condensation created on the wall may trickle onto the shelves and damage the bottle labels. In addition, contact with the cold wall may create a frost point, which is harmful to your wine.

Door security

In order to make your cabinet secure, all doors have a lock. You will find the key for this type of lock (figure 2) in the handle's box.

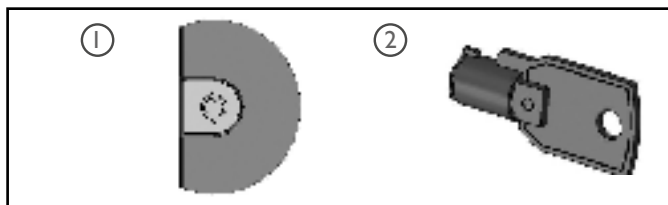

Installing two cabinets side by side

N.B.: If you are placing two cabinets side by side, ensure that you leave a gap of one to two cm between each cabinet.

Detachable lighting with LED

This accessory comprises:

- an adhesive support fixed to the inside of your door.
- an adhesive support in your accessories bag, in case you reverse the door.
- a tube made up of 4 LED in your accessories bag (diagram 1).

Tube is secured in place by simply inserting it into the adhesive support (1).

Changing the batteries: unscrew the cap on the side opposite the ON/OFF button (2) then remove the inner tube (3).

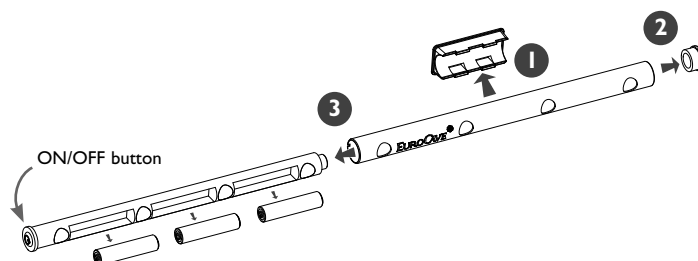

* Ref. AAA LR03



I. Door reversibility

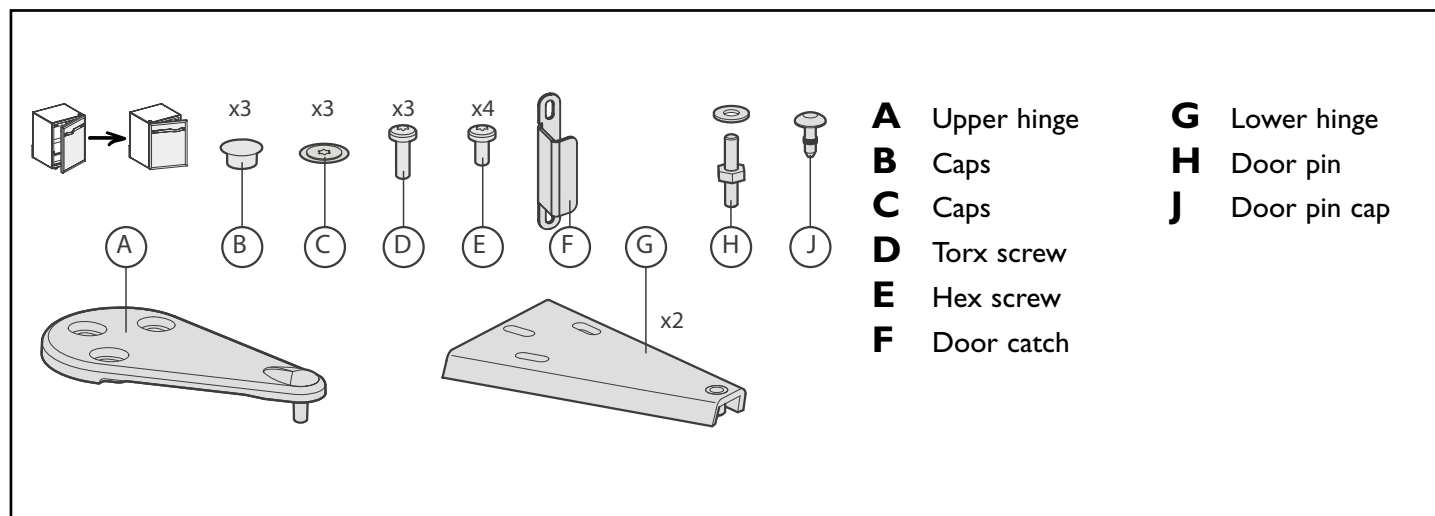

This allows you to change the direction in which the door opens. Follow the instructions below (example for changing a right-hand door into a left-hand door):

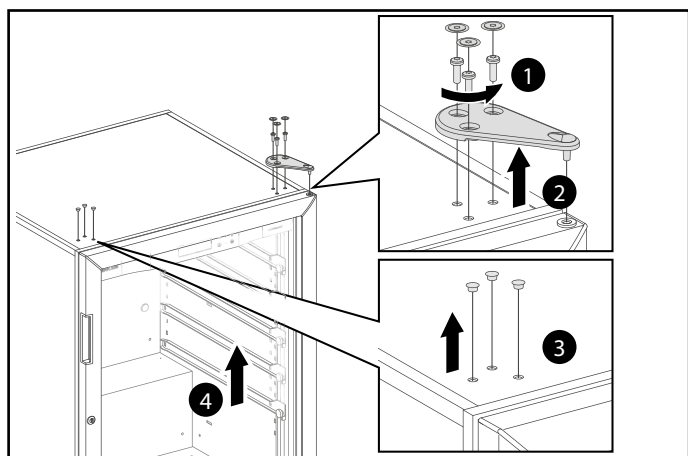

- 1** Unscrew the three screws using a "T25" Torx wrench.
- 2** Remove the upper hinge.
- 3** Carefully remove the caps using a thin blade.
- 4** Remove the cabinet door by opening it slightly, then lifting it upwards.

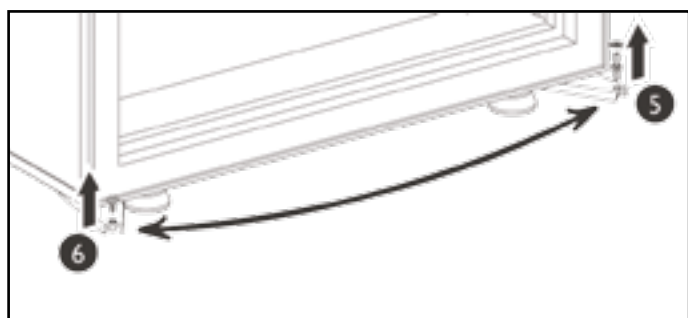

- 5** Unscrew the door pin.
- 6** Carefully remove the cap using a thin blade and assemble the pin in its place. Reposition the cap on the opposite side

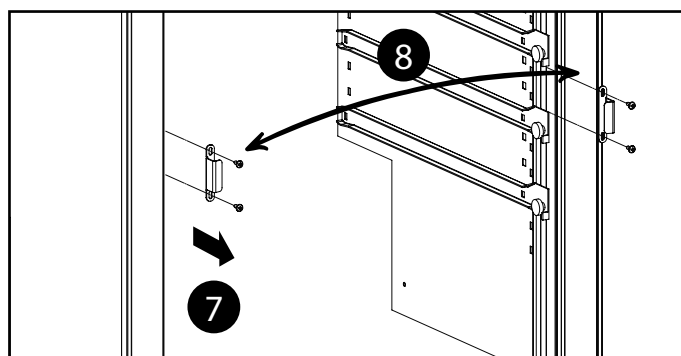

- 7** Unscrew the two screws and the door catch.
Unscrew the two screws on the opposite side and remove the two washers.
- 8** Mount the door catch on the desired opening side, using screws.
Replace the washers, then the screws, on the side opposite the door catch.

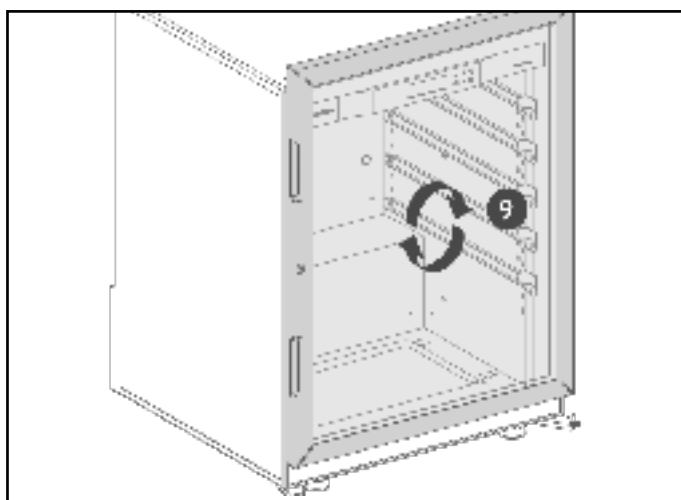

- 9** Turn the door through 180°.



Warning: the door is very heavy. Take any necessary precautions to ensure that you do not injure yourself or drop it.



4 - INSTALLING YOUR WINE CABINET

10 Put the door back on its pin.

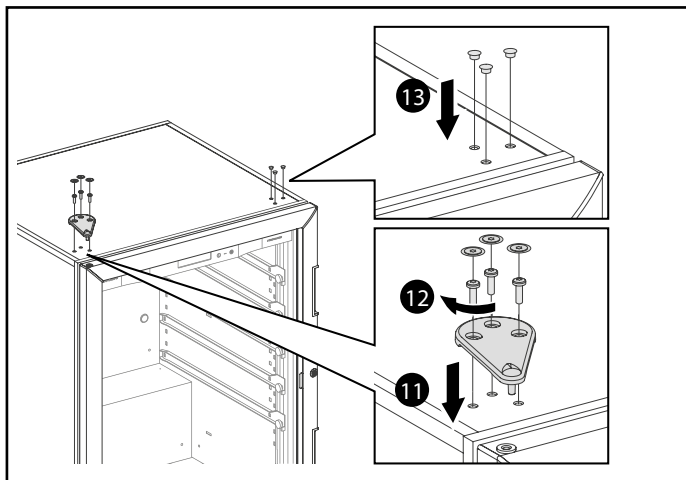

11 Put in place the upper hinge.

12 Screw the hinge so that the door is completely parallel to the cabinet.

Check that the door seal adheres well to the cabinet (by closing the door), to ensure that it is completely air-tight.

13 Put in place the caps.

14 As the door has been reversed, gently remove the lighting adhesive mounting support, now located at the bottom of the door. (only for glass door)

You will then find a second adhesive support in your accessories bag, to be positioned inside your door, at the top and the centre :

- glass door : under the seal
- solid door : see diagram below

To ensure that the lighting is correctly positioned, gently close the door.

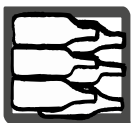
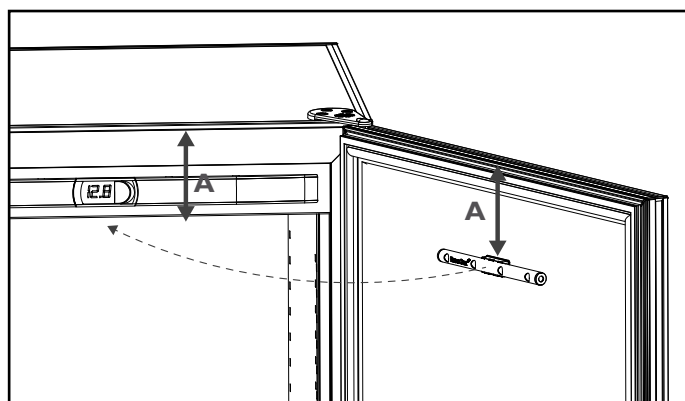

5 - LAYOUT — STORAGE



Your EuroCave cabinet was designed to be adaptable. Its storage equipment adapts to your requirements and can be added to over time.

Différents types de rangement

Different types of storage



Universal storage shelf
Ref.: AXUH

Capacity: 77 bottles
Max weight: 100 kg

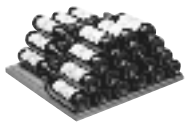

Bordeaux storage shelf
Ref.: AXBH

Capacity: 78 bottles
Max weight: 100 kg

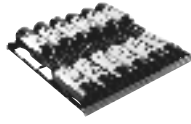

Universal sliding shelf fitted with "Main du sommelier" supports
Ref.: ACMS

Capacity: 12 bottles



Champagne sliding shelf
Ref.: ACHH

Capacity: 10 bottles



Magnum sliding shelf fitted with "Main du sommelier" supports
Ref.: ACGMS

Capacity: 7 bottles



Serving sliding shelf
Ref.: ACVH

Capacity: 20 bottles



Display shelf
Ref.: ACPH

Capacity: 22 bottles

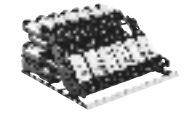

Articulated presentation kit for ACMS shelves
Ref.: AOPRESAR

Capacity: 32 bottles

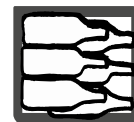

The layout of your cabinet can be modified according to your requirements. Refer to pages 111-112 to see storage simulations.

Layout advice

Your EuroCave wine cabinet has been designed to safely hold a maximum number of bottles. We recommend that you observe the following advice to optimize loading.

- Distribute your bottles as uniformly as possible over the various cabinet shelves, in order to spread the weight. Also ensure that none of the bottles is touching the rear wall of the cabinet.
- Spread the load over the entire cabinet rather than placing bottles all at the top or all at the bottom.
- Observe the loading instructions for the specific storage layout of your cabinet and never stack bottles on a sliding shelf.
- If you have sliding shelves, it is preferable to position them in the upper section of your cabinet to facilitate daily access.

Note: adjusting an ACMS/ACHH/ACGMS sliding shelf

When you purchase your cabinet, the sliding shelves are already adjusted to ideally suit the internal dimensions of your appliance. If you purchase a new sliding shelf, you may have to carry out this adjustment. To do so, unscrew the screws ① of the first right or left runner ② (2 screws) then position the runner at the desired width and tighten the screws. Repeat this process for the second runner (if necessary).

- In the same way, place one or two bottles of each of your different wines on the sliding shelves and keep spare bottles on the storage shelves. You then simply replace bottles when they are consumed.
- When using your wine cabinet, never pull out more than one sliding shelf at a time.



NB: Never modify the position of the stiffener in your V-Pure-L cabinet (see description page 6) without first consulting your retailer and never handle this part when the cabinet is loaded.

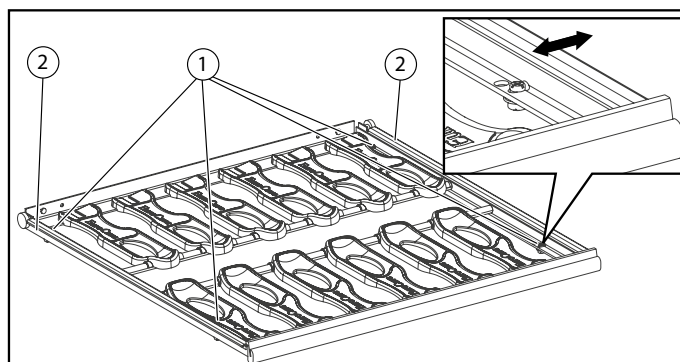

Adding or changing the position of a sliding shelf

If the sliding shelf is already in place in your cabinet:

- Completely unload the sliding shelf.
- Then remove the sliding shelf by sliding it towards you whilst lifting the front section.
- Remove the slide guides from the walls, marking off the right guide and the left guide.
- Refit the slide guides (see diagram below).

A. Putting in place the back section of the guide

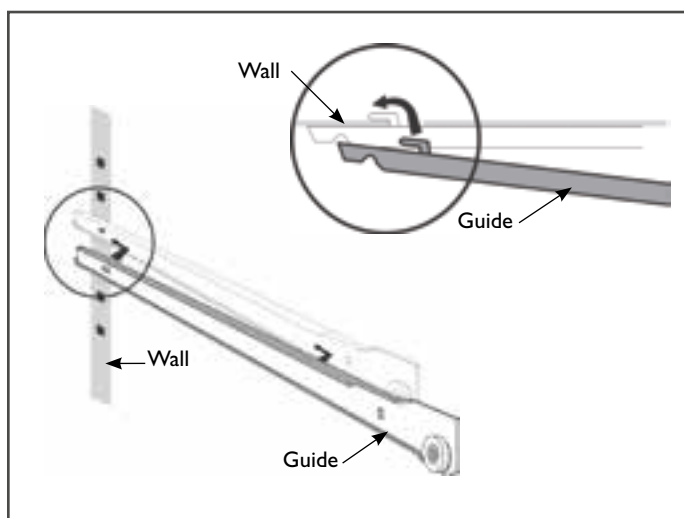

B. Putting in place the front section of the guide

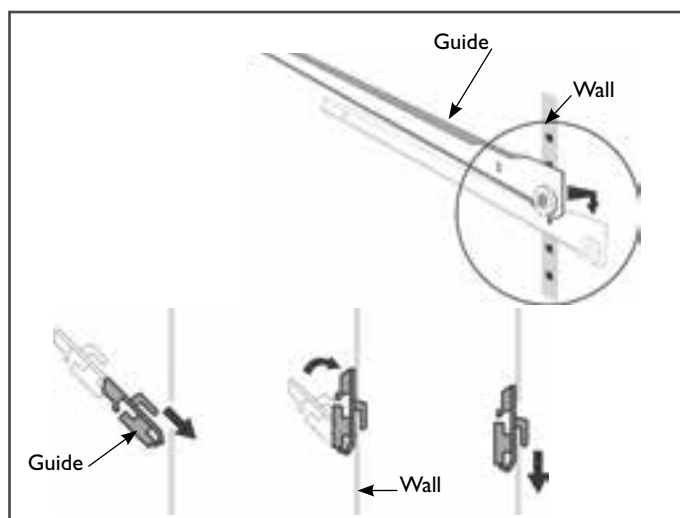

C. Then place the sliding shelf

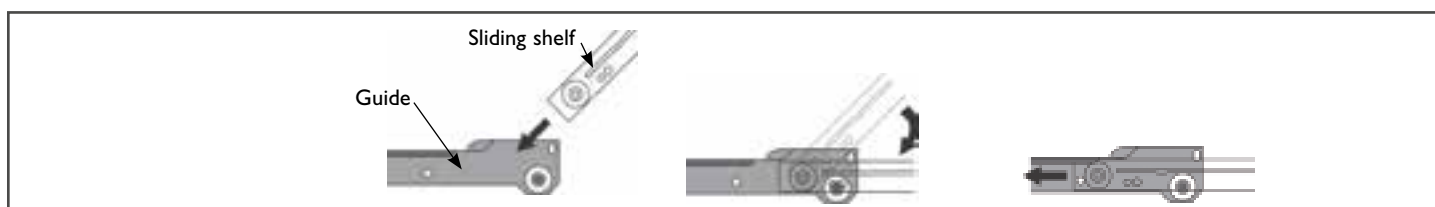





6 - COMMISSIONING YOUR WINE CABINET

I. Connection and starting up

Wait 48 hours before plugging in your wine cabinet.

- By default, the control unit is in the on position. To place the wine cabinet on standby, press and hold down the  button for several seconds.
- The display switches from the inside temperature to the **OFF** display (the wine cabinet is no longer operating, only the display is activated).
- To relaunch the wine cabinet control, press and hold down the  button for several seconds until only the temperature is displayed.



Have your plug checked (presence of fuses, amps and 30 mA circuit breaker).
Do not plug several cabinet into a multi-socket.



To ensure that your cabinet functions optimally, we recommend that you fill it to at least 75 % of its capacity.

II. Description

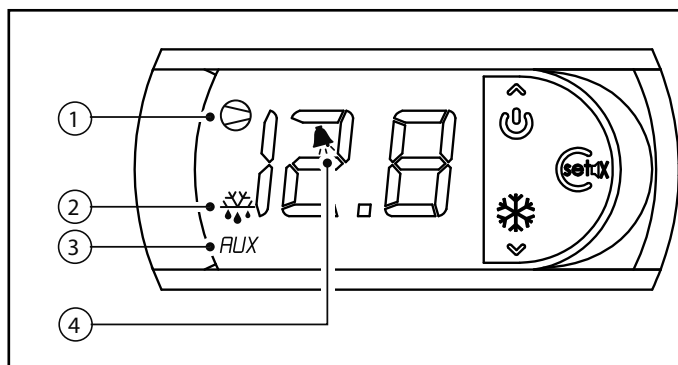

- 1 Compressor: indicates that the compressor is in operation. When it flashes, it means that the compressor is going to start in the next few minutes (time required to perform action).
- 2 Defrosting cycle: indicates that an automatic defrosting cycle is underway.
- 3 Heater: indicates that the heater is in operation.
- 4 Alarm: indicates an abnormally high or low temperature inside the wine cabinet.

III. Temperature setting

The temperature of your wine cabinet is set exclusively from the control panel.

- 1 Press and hold down the **SET** key for approximately 5 secs until the set temperature (**STI**) flashes.
The default temperature setting is 12°C (ideal wine maturing temperature). However, the temperature can be set from 9°C - 15°C.
The recommended setting range for storage is 10°C - 14°C.

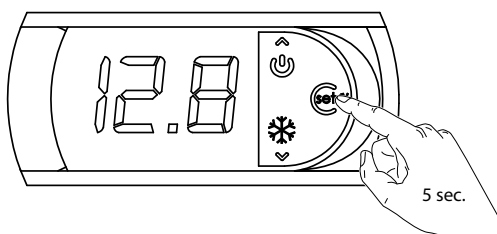

- 2 Set the desired temperature using the  and .



- 3 Confirm your programming by pressing the **SET** button. If you do not confirm your setting using this key, your modification will not be taken into account.

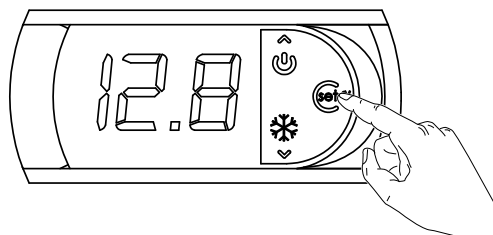

The value shown on the display is the actual temperature inside the cabinet. It is therefore necessary to wait before your new setting takes effect.



Alarms

If the temperature inside the cabinet is 6°C above or below the temperature setting, for over 18 hrs, the control activates the visual and audible alarm: the  warning light appears. Press the **SET** button to stop the alarm.

NB : If you have loaded your cabinet with a large number of bottles, it can take several days for your wine cabinet's temperature to stabilise. The alarm may then sound and the  warning light may then appear. Wait a while then check again. If the alarm still sound and the alarm warning light does not disappear, contact your retailer.

Warning: to function correctly, your cabinet must be placed in a room with a temperature of 0 - 35 °C / 32 - 95°F.

7 - EVERYDAY MAINTENANCE



Your EuroCave cabinet is a tried and tested appliance.

Maintenance operations to be carried out approximately once a year

- Unplug and unload the appliance.
- Clean the water drain at the bottom of the wine cabinet. Pay attention that nothing is blocking this drain.
- Regularly vacuum the condenser at the back of the appliance.
- Clean the inside of the compartments with water and a gentle cleaning product.
- Rinse thoroughly.
- Dry it with a soft rag.
- Replace the active charcoal filter in the breather hole at the top of your cabinet
- Remove the charcoal filter manually. It is available from your usual retailer. It must be replaced by an original manufacturer's part.
- Check that the seals are in good condition. It is often necessary to clean the door seal. Using unsuitable cleaning products can cause premature ageing of the seals. Certain rules must therefore be followed: whenever you clean the seal, always rinse off any cleaning product with clear water. All traces of cleaning product must be removed from the seal. EuroCave only recommends using a mild soapy solution. If this proves insufficient, it is possible to occasionally use an ethanol-based solution, provided that the concentration used is less than 10% and that the seal is then rinsed thoroughly with clear water.

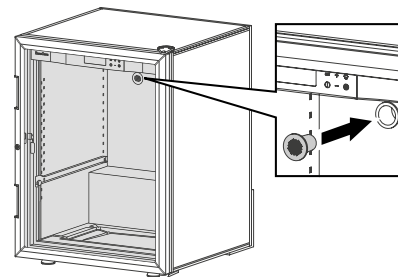

Regular monitoring of your cabinet and reporting any faults to your retailer will ensure that your appliance provides you with many years of faithful service.

Caring for glass elements:

- To clean the glass elements of your cabinet, use a non-abrasive soft cloth which has had a suitable glass cleaning product applied to it.

8 - OPERATING FAULTS



When starting up

- **The compressor does not work** > ensure that the wall socket is correctly supplied with power by plugging in another electrical appliance.
- **The compressor never stops** > put your hand on the condenser (grille located at the back of the appliance). If the condenser is cold, contact your retailer. If the condenser is warm, set the temperature (ST1) of your wine cabinet to 15°C, the maximum value in the setting range. If the compressor still does not stop, contact your retailer.



ANY WORK CARRIED OUT BY TECHNICAL SERVICES NOT APPROVED BY EUROCAVE SHALL RENDER THE WARRANTY NULL AND VOID.



The use of glass doors can alter your wine cabinet's performance in some extreme temperature conditions.



If your appliance does not seem to be working correctly, contact your EuroCave retailer.

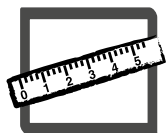

9 - ENERGY AND TECHNICAL FEATURES

Première									
	Height**	Width	Depth***	Weight when empty	Weight when empty	Electrical power*		Recommended temperature range	
				Glass door	Solid door	230V-50Hz (R600a gas)	115V-60Hz (R134a gas)	Glass door	Solid door
	(mm)	(mm)	(mm)	(Kg)	(Kg)	(Watts)	(Watts)	Min T° (°C / °F) - Max T° (°C / °F)	
I temperature									
V-PREM-L	1825	680	690	92	78	70	100	0-30 / 32-86	0-35 / 32-95
V-PREM-M	1480	680	690	79	68	65	95	0-30 / 32-86	0-35 / 32-95
V-PREM-S	960	680	690	56	49	60	90	0-30 / 32-86	0-35 / 32-95

* Electrical power per 24hrs measured with an external temperature of 25°C / 77°F

Control accuracy: +/- 1°C (2°F), display accuracy: +/- 1°C (2°F).

** Height including the top hinges and the feet, adjusted to mid-height.

*** Depth without the rear stop.

Technical features and data relating to European regulations on power consumption

Ref.	Types of doors	Energy efficiency rating ¹	Annual energy consumption AEc ² (Kwh/an)		Useful volume (litres)	Temperature of the other compartments ³	Acoustic emissions (dB(A))	
Première			230V-50Hz (R600a gas)	115V-60Hz (R134a gas)			230V-50Hz (R600a gas)	115V-60Hz (R134a gas)
I temperature								
V-PREM-L	Solid	A+	128	183	460	-	37	38
V-PREM-L	Glass	A	165	256	460	-	37	38
V-PREM-M	Solid	A+	121	165	355	-	37	38
V-PREM-M	Glass	A	157	219	355	-	37	38
V-PREM-S	Solid	A+	114	146	225	-	37	38
V-PREM-S	Glass	A	146	183	225	-	37	38

1- Only concerns 230V-50Hz models (R600a gas).

2- Power consumption calculation based on the result obtained over 24 hrs in standard test conditions (25°C/77°F). Actual power consumption depends on the appliance's location and operating conditions.

This appliance is intended exclusively for wine storage.

Category of all models: 2

Climate class: Our appliances are designed for use at an ambient temperature of between 10°C and 32°C (50°F and 90°F) (Class SN). Nevertheless, refer to the technical properties tables (p16) for the optimal performance levels of your product..

These appliances cannot be built-in.

3- red serving temperature

Standards

Your product complies with the following standards:

1- SAFETY - Directive 2006/95/CE

Standards EN60335-1:Version 5 - 2010 +A1 + A2 + A11 + A12 + A13
EN60335-2-24:Version 7 - 2010 + A1 + A2 + A11

2- EMC - Directive 2004/108/CE

Standard EN55014-1/2

3- ENVIRONMENT - Directive 2010/30/EU

Directive 2010/30/EU
Regulation 1060/2010



R600a

Depending on the country, EuroCave wine cabinets may contain flammable refrigerant gas (R600a: ISO BUTANE).